

# Woodworkers Club

## OF HOUSTON

VOL. 9, NO. 4

APRIL, 1993

### Officers

Bud Froelich - President 859-6620  
Ted Kurland - Vice President 729-4693  
Joe Wainright - Sec./Treasurer 666-8475

Sharon Buckley - Newsletter Editor 944-6739

### Board of Directors

Art Chester - 469-1990  
Jack Conry - 463-7352  
Denis Muras - 943-7745  
Bill Smith - 356-6509

### PRESIDENT'S CORNER

By Bud Froelich

At our last meeting there were a number of people who got up and told us about various types of allergic reactions that they had with different kinds of wood ranging from cocobolo to mesquite. My initial thought was-perhaps I should stop working with exotic woods and just use domestic hardwoods. But didn't I read that domestic cherry had a high degree of arsenic in it? I remember, however that one fellow said that as long as he had a respirator he didn't experience any problems with cocobolo. Then I remembered a similiar problem I had with kingwood, my eyes watered, I started choking and coughing and the whole shop was filled with kingwood dust, it wasn't until I went outside that I got better.

The kingwood dust was made by my super-duper Bosch variable speed 4 x 24 sander with a 240 grit belt. I added even more kingwood dust to the air in my shop with my super-duper Bosch variable speed orbital sander with a 320 grit disk on it. Not once did I consider using one of the many not so super-duber cabinet scrapers that I have, that would be so "low tech" and besides with my hi tech sanders I can get a hi tech respirator and a hi tech dust collector and a hi tech air cleaner. Is it the wood we work or how we work the wood? Am I getting a reaction to "hi tech"? What are your thoughts on this?

### FIELD TRIP AND BAR B QUE

David Marsh of David Marsh Furniture has invited us to visit his Houston workshop and to a Barbecue. David's shop is at the corner of Detering and Blossum. The only large Metal building on the street. The date is April 17th, the time will be between 11:00 A. M. and 2:00 P.M. At the next meeting we will need to get a count on how many of us will attend so David knows how much food to prepare.

We are still scheduled for a May visit to the

Visseroland organ shop. Date to be announced in the next newsletter.

### ANTIQUE WOODS OF TEXAS

Last month we talked about the 95 year old grain elevator that was being dismantled in Port Arthur, Texas by the Davies Rail and Mechanical Workes, Inc. Nearly two million board feet of longleaf yellow pine from the virgin forest of South East Texas were milled by the Lutcher and Moore Lumber Co. of Orange for its construction. The magnificent longleaf soared 100 to 200 feet in the air with bases 4 or 5 feet in diameter.....often 50 or 60 feet to the lowest limb. Angela Schnuerle, President of Davies Rail wants the wood kept in Texas and is willing to sell amounts in any quantities. Timbers range in size from 13" x 13" to 24" x 24" x 27 feet long, also available is 2 x 6 and 2 x 8 at various lengths, to shorter pieces available for picture frames, carvings, small furniture, etc. Prices range from as little as 50 cents to over 2.25 a board foot. They are open during the week and sometimes on Saturday, but its best to call first, Port Arthur number 409-985-8847, Houston number 713-449-4717.

### PASADENA TOOL SHOW

Pasadena Industrial is having its Annual Tool show on Friday April 23, Saturday April 24 and Sunday April 25. To get in free just say Johnny sent me, and you will receive special show prices, demonstrations, a chance to try out that tool before you buy it and free hot Dogs and drinks. Easy to get to by way of Hwy. 225 off of the South Loop 610, just look for the big tent. See Add on inside back page.

### LOS AMIGOS DE MESQUITE SHOW

The date and location has been set for the Los Amigos de Mesquite show will be the weekend of September 29th at the Adams Mark Hotel. The Club will sponsor a table for the show and any member will be able to

---

sell their items made of Mesquite or accented with mesquite. This is the first time that the show will be held in another city other than Austin and we would like it to be a big success. Enclosed in this newsletter is a list of suppliers for Mesquite. So at least start thinking about what you would like to make and lets have a good showing of the members work. We will let you know more about the show as we are so informed.

### **PROBLEMS AND SOLUTIONS**

Norm Newberry told about a very allergic reaction (similiar to poison ivy) that he had to cocobolo. While he was working with this wood he wore a respirator and had no reaction, but when he cleaned up his shop he did not use a respirator. That night he had chills and fever, he then developed hives which he treated with Caladryl and it seems ok. But the next day it reoccurred and Norm went to the Doctor and the Doc prescribed anti-biotics. The next time he cleaned up he used his respirator and had no reaction.

### **FEATURE PROJECT FOR MARCH**

#### **TABLE TOPPERS**

Lewis Vallette made a turned lamp of 51 pieces of wood with a clock in the side. Because of the shape of the lamp and the diameter of the clock, he had to make his own fly wheel cutter to accomodate these problems.

Bob Gallant made some laminated scrap wood napkin rings.

### **FEATURE PROJECT FOR APRIL**

Fun time at the feature project segment--white elephants- no we don't want any actual white elephants-what we want is your first project or your worst project. That project that is so bad or so ugly, so tacky, so badly made that you have hidden it from the world--dig it out, dust it off and bring to the meeting. Lets all have a good time with this one.

### **SHOW AND TELL**

Leonard Elkholtm made a raised panel toaster cover that was a little small and then became a waste basket. Leonard also made a laminated mallet with his initials inlayed.

Dan Shaklovitz showed us an Heirloom Toy Chest that he made for his grandchild. He got the plans from the Woodworkers Journal. The chest has a ventilated top for safety and a hinge that will stop at any position and will not slam shut on your fingers.

Walt Turpening made a stool with rounded through tenons, each custom fit to each hole and secured with cherry wedges. For his wife he made a weaving bench out of maple and walnut finished in Watco.

### **APRIL MEETING AND APRIL BOARD MEETING**

Please note that because of Easter we will have to move our meeting date up one week

---

---

to April 3, that's the first Saturday instead of the second Saturday. The Board meeting will be held following the regular Saturday meeting instead of the following Thursday evening.

### **VIDEO TAPE LIBRARY**

We have purchased two new tapes for the library on wood turning. The tapes are on Hollow Vessel Turning and Bowl Turning, each tape is two hours in length. They will be available at the April Meeting.

### **OUR ANNUAL CHARITY EVENT**

The Board has been discussing ways for the members to continue with some form of assistance to the community, but maybe not with a sale. The North Texas Woodworkers Assn. that visited us a couple of months ago got a request from a childrens home for footlockers so that the kids could have a secure place to put their belongings. So far they have made 61 and are in the process of making another 39.

We thought making something of wood that children could use might be a better idea than a sale and just donate money. If you have any ideas or suggestions or just don't like this idea we will take any suggestions. We thought that we could set up groups to work in members shops around Houston to do this. This would also be a good way to meet and work with other members. If you would be willing to host a group let Bud know.

## **APRIL MEETING**

**WHEN: APRIL 3RD, 1993 9:00 A. M.**

**WHERE: BAYLAND COMMUNITY CENTER  
ON BISSONNET AT HILLCROFT**

**PROGRAM:** The program will be presented by Leslie Mizell from Cleveland, Texas. Leslie make furniture out of Mesquite, if you would like to see one of his chairs take a look at Fine Woodworking Magazine page 97 in the November/December 1992 issue. The article shows a Texas Chippendale Chair which features the lone star carved on the back splat, a crest-rail armadillo and the silhouette of the Alamo at the base of the splat. Leslie will show us how to carve a ball and claw foot out of Mesquite and a few other Mesquite techniques.

---

**MESQUITE LUMBER PRODUCERS**

February 17, 1993

Americana Mesquite  
411 St. James Street  
Gonzales, TX 78629  
(512) 672-8386  
Contact: David Blankenship

ECC Shop, Inc.  
2105 Galveston  
Laredo, TX 79040  
(512) 732-7151/7820  
Contact: Evan Quiros Sr.

Frank Paxton Lumber Co.  
P.O. Box 17968  
Austin, TX 78760  
(512) 443-0777  
Contact: Larry Cook

Hardwood Lumber Co. of Dallas  
10551 Goodnight Lane  
Dallas, TX 75220  
(214) 869-1230  
Contact: Wright Cain

Mesquite Lumber & Crafts  
Box 68  
Knippa, TX 78870  
(512) 934-2616  
Contact: Herb Nordmeyer

Mesquite Production Company  
Rt. 1, Box 68-B  
Hondo, TX 78861  
(512) 426-3000  
Contact: Blake Barnette

Mesquites Unlimited  
Rt. 4, Box 322  
Wichita Falls, TX 76301-9549  
(817) 544-2262  
Contact: Cameron Harrison

Mesquite Products of Texas  
P.O. Box 88  
Bulverde, TX 78163  
(512) 438-3118  
Contact: Jim Butcher/Doug Florence

Bob Moon  
Box 350  
George West, TX 78002  
(512) 449-1411

Jim Prewitt  
Box 269, Hwy. 77  
Kingsville, TX 78363  
(512) 592-5948

Wallace Seabolt  
Rt. 2, Box 171A  
Alleyton, TX 78935  
(409) 732-5663

South Texas Fine Woods  
4326 Hwy. 90 East  
Uvalde, TX 78801  
(512) 278-1832  
Contact: Robert Henserling

South Texas Moulding  
P.O. Box 549  
Alamo, TX 78516  
(800) 444-2881/(512) 383-2233  
Contacts: Dennis Seal  
Gary Wilscher

Texas Kiln Products  
Rt. 2, Box 171D  
Smithville, TX 78957  
(800) 825-9158  
Contacts: David Miller  
Richard Lowery

Uvalde Mesquite Products  
1817 Garner Field Road  
Uvalde, TX 78801  
(512) 591-0404/278-3093  
Contacts: Robert Champion  
Roy Cothman

Bob Warnecke  
532 Rock Street  
New Braunfels, TX 78130  
(512) 625-5864

Pasadena Industrial Presents *Our Spring '93*

# Power & Hand Tool Show

Free Hot Dogs  
Drinks  
Lots of Door Prizes!

## April 23, 24 & 25

**Fri 12 - 5:30 Sat 8 - 5:30 Sun 12 - 5:30**

*Just Tell em "Johnny Sent Me!"*

222 West Pasadena Freeway, Pasadena Texas 77536 472-5588

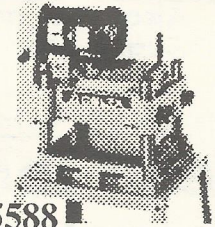

5117 April Lane, Houston, Texas 77092  
Hours: M-F 7:30-5:00 SAT 8:30-12:30  
**(713) 686-6176 Phone**  
**(713) 686-3217 Fax**

### DOMESTIC & IMPORTED HARDWOODS

Ash, Basswood, Birch, Cedar, Cherry, Cypress, Mahogany, Maple, Red Oak, White Oak, Padouk, Poplar, Purpleheart, Redwood, Sycamore, Teak, Virola, White Pine, Walnut, and More.

High Quality Domestic & Imported  
Plywoods, Softwoods, Hardwood Veneer  
Edgebanding & Hardwood Veneers  
**Excellent Service & Competitive Prices!**

ON SITE CUSTOM MILLING  
TO YOUR SPECIFICATIONS,  
S2S, S2S1E, S4S  
(No order too large or too small) 10/93

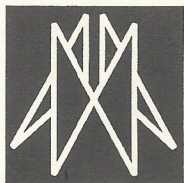
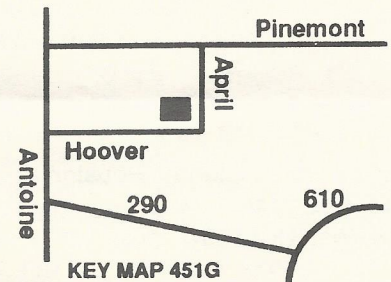

## AUSTIN HARDWOODS

13001 VETERANS MEMORIAL DR.  
HOUSTON, TEXAS 77014

### 440-0764

We stock over 80 species of lumber including rare exotics and turning stock. Plywood, Veneer, Moulding, Flooring, Tools, Millwork, Paneling Etc. also available

Exp. 2/93

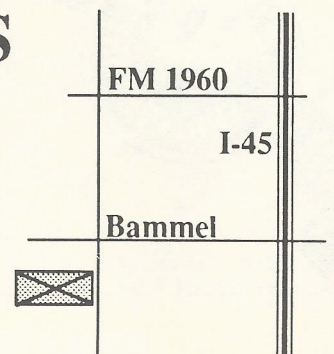

# HARDWOOD LUMBER CO.

700 E. 51/2 St. (In The Heights)  
Houston, Texas 77007  
(713) 862-6628  
Hours: M-F 7:30-5:00, Sat. 8:30-1:30

We stock over 65 species of lumber including  
hard to find exotics!

**Also:** Plywood, Veneer, Moulding, Formica,  
Custom Milling, Woodworking Tools, Books, etc.

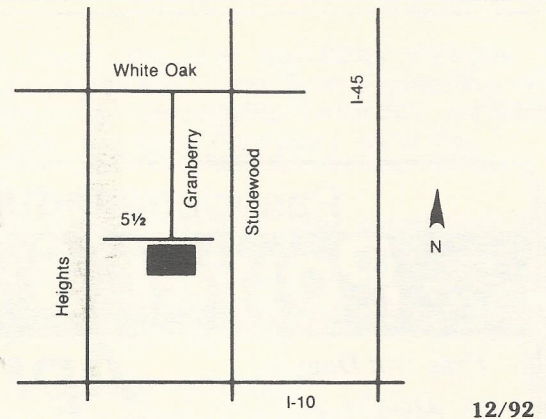

## Send Today for the Most Complete Catalog Selection of Woodworking Supplies

Please Enclose \$1.00 (3rd class) or \$2.00 (1st class)

Name \_\_\_\_\_

Address \_\_\_\_\_

City \_\_\_\_\_ State \_\_\_\_\_ Zip \_\_\_\_\_

**Orders Shipped Within 48 Hours**

7/93

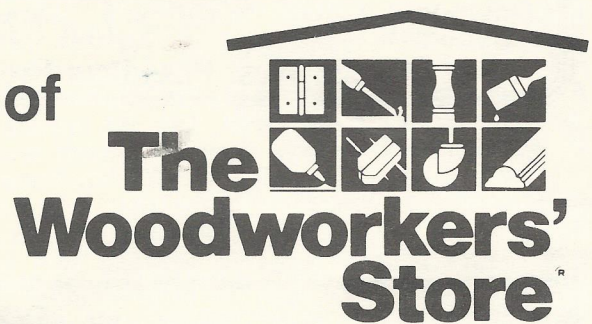

21801 Industrial Blvd., Rogers, MN 55374

PRINTED BY SPEEDY PRINTING SERVICE OF TEXAS 3727 W. ALABAMA, HOUSTON, TX. 77027 (713) 877-8466

Woodworkers Club of Houston  
P.O. Box 34481  
Houston, Tx 77234

