

WOODWORKERS

CLUB OF HOUSTON

VOL. 4, NO. 8

AUGUST, 1988

Officers

Sharon Buckley - President
Kent Moore - Vice President
Don Richardson - Sec./Treasurer
Steve Procter - Newsletter Editor

Andy Anderson - Board of Directors
Jimmie Harp - Board of Directors
Ron Kuenning - Board of Directors
Hebert Wilbourn - Board of Directors

JULY MEETING

Our Guest speaker for the July meeting was Roy Bailes, Sales Manager for Hardwood Lumber Co. Roy has 35 years experience in the business and his talk was most informative. A summary of his talk follows. Thanks to Roy for his excellent talk.

There are three types of woods:

Conifers--cone and needle, evergreen
Deciduous--drops leaves (except cyprus)
Palm--unique wood, used by some islanders

Only 10% of total tree species are marketed as lumber. Reforestation projects are conducted by almost all major firms in the U.S. Roy doesn't think we'll ever run out of hardwoods, although they may get expensive and smaller.

Lumber is sold in quarters--4/4, 6/4, etc. up to 16/4, rough.

Four inches is about the limit of most kilns to properly dry wood.

Log width is shrinking--walnut over 10" wide now uncommon. Normally 5-6" and wider is top grade.

Rough--size from mill
Dressed--planed two sides
Surfaced--S2S S4S

Grades:

FAS (first and seconds)	87 1/3% Clear
Select & Better	75% Clear
#1 Common	66%
#2 Common	50%

Firewood (just kidding--there are some #3 common but it's uncommon!)

Cutting:

Flat Sawn most common
Quarter Sawn--usually oak or ribbon mahogany
Rift--cuts across growth rings very evenly

Redwood has very high moisture content. Most woods have 35% to start, must be below 20% before kiln drying. Oak is difficult to dry properly--susceptible to cracking.

You can dry lumber yourself in controlled area--don't put it in the attic or it could season crack too fast.

You can tell moisture content by feel--weight of wood, as well as how long it's dried. Hardwood Co. lumber will allow the use of a moisture meter free to check the wood.

Again, our thanks to Roy for his discussion.

NEW BUSINESS

A field trip to Coldspring, Texas on July 30 was announced to see a working Hardwood Kiln. B. A. Dove is in the process on installing a saw mill.

Don Richardson our Treasurer reported that we have \$1926 in the Treasury at the 1/2 year mark.

WORKSHOPS AND CLINICS

For the month of July Bill Beggs held his popular Bandsaw Box Clinic.

In September Don Richardson will hold a Computer Aided Drafting Clinic.

Remember all the Clinics are held on the 3rd Saturday of each month.

If you sign up for a Clinic---Please show up or be sure to call the person giving the Clinic to tell them you can't show!

PRESIDENT'S CORNER

By Sharon Buckley

Again I would like to thank Way Engineering and Steve Procter for allowing us to use their facility for our meetings.

You might be wondering if we are ever going to meet at a woodworking related business.

Andy and I thought we had a furniture manufacturer lined up for August but this to has fallen through.

We do have confirmation on a Panel Manufacturer for our September meeting.

Next Month you should notice an improvement in the quality of the type in the newsletter. We have purchased an update for our newsletter program--that has an improved type quality.

The officers and Board Members have asked Murray Gordon to look into the availability of any new video tapes that would be of interest to the members. Have you seen any that might be of interest -- let Murray or any officers hear from you.

A group of woodworkers and their wives drove up to Coldspring for an interesting visit to B. A. Dove's Allwood Products.

B. A. explained the process of going from the tree to a piece of lumber. Most of the members went inside of the kiln, at 120 degrees no one stayed to long inside.

I was told that this weekend was Trades Day--It is actually the 4th weekend of the month--which is usually the last Saturday and Sunday--except this July had 5 weekends and not the usual 4.

B. A. demonstrated the straight line rip and a custom made 7 1/2 HP 20 inch Pendulum Saw for crosscutting.

Many of the members purchased some walnut, ash and oak during their visit.

I looked up and Jimmie Harp was climbing on top of a Ten Foot stack of Oak.

PROBLEMS AND SOLUTIONS

Bell Beggs has a source for green spalted Pecan -- he needs friends with chain saws.

Joe New wants the easiest way to paint Fir ? (with as few coats as possible.) Enamel undercoat(oil-based) is a good one step paint.

How can you prevent saber saw blades from curving in work ? Don't push too hard, or too fast, use straight edge or cut from the bottom side.

How can you keep paint from peeling on metal surfaces? Use a primer used on oil rigs.

SAFETY

By Zatis Murphy

Sorry, but Mr. Safety is on vacation.

BUY AND SALE

For Sale: 4 inch Shopsmith Jointer \$250.00
12"x 4" Shopsmith Planer \$500.00
both tools can be used on a Shopsmith or you can add a motor and build a stand. Murray Gordon.

For Sale: Antique Tools. Bob Soderblom.

For Sale: Rockwell 11"x 36" Lathe with knives. 1/2 HP motor and factory stand. Brand new--used 30 minutes \$450.00 Victor Theriault--288-4075.

Want to Buy: Used Table Saw, Used Jointer James Mainwaring 957-2369.

It was announced that a Makita 12" Planer with Jointer was for sale at the Big State Pawn Shop at 7200 Longpoint.

SHOW AND TELL

Bill Beggs got tired of sitting on a hard wooden stool (or should we say his bottom got tired) so he made himself a padded shop stool with back rest. He got the plans from WOOD magazine plans call for using 3" lag screws and butt joints in ash.

Ken Wallis has really gotten good at making turned bowls using the Stave bowl construction. He only started turning bowls after his cataract operation and was told to take it easy for a while.

Ken comes the farthest for our meetings, from Nacogdoches, which takes about 3 hours.

Ken and Henry Reed started at 4:00 friday making a turned staved bowl which they showed us at the meeting--It was almost finished except for a little sanding and a finish.

Ken showed us various bowls and toothpick holder. He uses Titebond glue--When gluing a lot of section, glue half first, otherwise wood will move. He uses newspaper to separate bottom from lathe.

Suggestion--use Paper Towels instead of rags to apply Bartley's Paste Varnish.

CLUB NEWS

Jimmie Harp has started his group projects for the Charity Show. If you would like to work with his group---it meets every Monday Night 7:00 PM to 10:00 PM.

Chuck Maxwell and Sharon Buckley would like to start a daytime group project if there is enough interest. If you would like to participate, contact Chuck or Sharon to sign up.

SHOP TALK

By Don Sloan

Don's article this month was so hot the Post Office confiscated it. (Just Kidding)

Don's article and all of the Newsletter is lost some where between Steve's office and Sharon's house. Luckily the core of the newsletter was on a word processor and we were able to reproduce it.

TRASH OR TREASURE ?

If you are like many other home craft workers, you dislike throwing anything away---even sawdust. So here is what I do with many of the items that seem to accumulate around my shop.

Sawdust is gathered up and dumped on a

"compost" pile in my back yard. Most kinds of sawdust and shavings will decompose within a few weeks and will add to the richness of the material.

I usually buy glue in, at least, a one quart container. I have found that a "French's" Mustard plastic bottle makes an excellent means of dispensing a smaller amount of glue to your work. This container has an easily controlled spout and this spout can be pried off for filling. Be sure to clean and rinse out the bottle, before filling it, as the lingering mustard odor will cause you to have an insatiable desire to have a "hot-dog" each time you use it!

For dispensing small amounts of glue, I have found that a plastic Visine (eyedrop) container works great! It has a tight, screw on cover, and is easily filled.

Empty coffee cans seem to be used quite often for cleaning paint brushes, etc. I have come up with an addition to the can that seems to add to the usefulness of this scheme. I cut a piece of hardware cloth or similar metal mesh, approximately 2 inches in diameter larger than the can. I then use wire cutters and pliers to bend down approx. 1 inch of the mesh all around so that it can be inserted into the coffee can--forming a platform, resting off of the bottom by about 1 inch. Brushes can be stroked across this mesh to facilitate cleaning and there is space in the bottom of the can to accumulate debris without getting back on the brush. I pour paint thinner or other solvent into the can to about 2 inches above the mesh. Use the plastic cover and you will find that this will be useable for several months before you will have to dump out the old fluid. Save the mesh for the next can.

BOWLING ALLEY MAPLE

Ken Wallis has offered to pick up small quantities of the bowling alley maple and deliver it to the meeting for anyone interested. He pays 17 1/2 cents per linear foot and will sell it for 20 cents a linear foot for his trouble.

I purchased 100 LF for \$20.00, it was very good quality---Remember these are drops, pieces range from appx. 20" to 36".

AUGUST MEETING

WHEN: AUGUST 13, 1988 9:00 A.M.

WHERE: WAY ENGINEERING CLASSROOM
5304 ASHBROOK

PROGRAM: THE HOW TO OF ROCKING
AND CAROUSEL HORSES.

Steve and Vicki Procter have been studying and building speciality rocking and carousel horses for the last couple of years. They will share with us some of the problems, solutions and joints used in constructing a speciality horse.

DIRECTIONS: Take 610 Loop and exit at Fournace/Bissonett, which is the first exit South of the Southwest Freeway(Hwy. 59). Turn west onto Fournace. Proceed to Royalton and turn South, go to the next street which is Ashbrook turn west.

SEE YOU THERE !!!!!!!!!!!!!!!!!!!!!!!!!!!!!

NEWSLETTER INFO

THE SEPTEMBER NEWSLETTER

LAST DAY FOR PUBLISHING-----AUGUST 25, 1988

THE NEWSLETTER WILL BE MAILED THE WEEK OF SEPT. 5TH.

NOTE: ON VIDEOTAPES

Video tapes can be mailed back to avoid the \$5.00 fine.

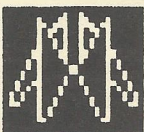

AUSTIN HARDWOODS

13001 VETERANS MEMORIAL DR.
HOUSTON, TEXAS 77014

440-0764

WE STOCK OVER 80 SPECIES OF LUMBER INCLUDING
RARE EXOTICS AND TURNING STOCK

PLYWOOD, VENEER, MOULDING, FLOORING, TOOLS,
MILLWORK, PANELING, ETC. ALSO AVAILABLE

	FM 1960	
		I-45
	BAMMEL	
■		

Exp. 8-89



Woodworkers Club of Houston
P.O. Box 34481
Houston, TX 77234

ALLWOOD/SCHROEDER INC

Imported & Domestic

Marine Plywood
Parana Pine
Mahogany

Teak
Exotic Hardwood
Domestic Hardwood

Quality
Hardwood - Softwoods - Plywood
Mouldings & Squares
Self-service

A complete selection of finishing supplies

WALNUT - BIRCH - ASH - CHERRY
CYPRESS - RED AND WHITE OAK
SUGAR PINE AND OTHERS
MON - FRI 8:00 TO 5:00

SAT - 8:00 TO 1:00
5401 Lawndale
(713- 921-6131)

Exp. 5/89

HARDWOOD LUMBER CO.

700 E. 51/2 St. (In The Heights)
Houston, Texas 77007
(713) 862-6628
Hours: M-F 7:30-5:00, Sat. 8:30-1:30

We stock over 65 species of lumber including
hard to find exotics!

Also: Plywood, Veneer, Moulding, Formica,
Custom Milling, Woodworking Tools, Books, etc.

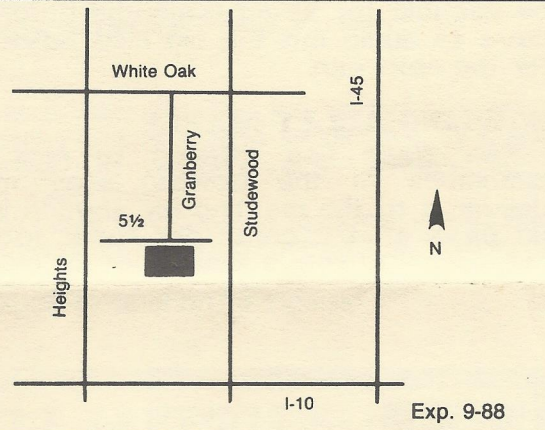

Exp. 9-88

Send Today for the Most Complete Catalog Selection of Woodworking Supplies

Please Enclose \$1.00 (3rd class) or \$2.00 (1st class)

Name _____

Address _____

City _____ State _____ Zip _____

Orders Shipped Within 48 Hours

Exp. 5/89

21801 Industrial Blvd., Rogers, MN 55374

