

# Woodworkers Club

## OF HOUSTON

VOL. 9, NO. 2

FEBRUARY, 1993

### Officers

Bud Froelich - President 859-6620  
Ted Kurland - Vice President 729-4693  
Joe Wainright - Sec./Treasurer 666-8475

### Board of Directors

Art Chester - 469-1990  
Jack Conry - 463-7352  
Denis Muras - 943-7745  
Bill Smith - 356-6509

Sharon Buckley - Newsletter Editor 944-6739

### PRESIDENT'S CORNER

BY BUD FROELICH

Why in the world do I go out almost every night after a hard day at the office and work in my shop for 2 or 3 hours? What drives me to think about new projects and better ways of doing things in my shop? What's so important about my woodworking that I would risk life and limb (or perhaps just part of a limb) to do it?

Perhaps it's my wife who says "Honey! We sure could use a . . ." or perhaps it's me saying "Ya know mom----this kitchen table is kind of small and wobbly." It could be my daughter who could say "Dad"! Allen and I were wondering if you could make us a . . ." But there's something more to it than that. My mom has a rocking chair that was made and passed down to her from her grandfather. That chair is a link to those in our family who made it and used it, a legacy of our past. Perhaps you and I don't want to be remembered by the "plastic" chair sitting in our grandchild's garage that is used as a stool to get paint cans down off a high shelf. No--you and I don't want that--we want a place of honor in the family, we want to be remembered for the work we did and the creations we left behind.

### ANNUAL DINNER FELLOWSHIP

Get those show and tell items ready for the Big Show and Tell at our Dinner, held this year on Saturday February 27th at the Ramada Inn at 12801 Northwest Freeway (Highway 290). For further information see enclosed Registration form and for the menu refer to the January Newsletter. DEADLINE FEBRUARY 20, 1993.

### SAFETY R S I----Repetative Syndrom Injury BY ZATIS MURPHY

Repetative use of any muscle can cause permanent injury--we have all heard of Tunnel Carpel Syndrom an injury to the hand sometimes requiring surgery. To avoid these

muscle injuries--take frequent breaks--stretch those muscles--use a Tennis ball to exercise those hand muscles.

### LIFTING IN THE WORKSHOP--Back Injuries--

80% of us have serious back problems.

Keep your back straight--do not bend at the waist and pick up with your back--use your legs.

Do not lift and twist at the same time--keep the item you are lifting close to your body.

### THANK YOU

We received a Thank you note from the Make-a-Wish Foundation for our donation from our Charity Sale.

### VISITORS FROM OTHER CLUBS

At the January meeting we had visitors from the North Texas Woodworker's Association from Richardson, Texas, they left the Dallas area at 3:00 in the morning to get to our meeting.

We also had a visitor from the Gulf Coast Woodturners Assn. President Joe Heil. Joe invited us to join them in this years Los Amigos de la Mesquite show which will be held sometime in September at the Adam's Mark Hotel. The club members will be able to sell their products at the show, any item that you put on display for sale should be made up of 75 to 85% mesquite. So start thinking now of what you can make, we will also need to get a few members together to coordinate this project if you would like to participate please contact Bud.

### PROBLEMS AND SOLUTIONS

Bob Boteler suggests using carbtorator cleaner for cleaning those oiled whetstones.

It was also suggested to really clean those oiled whetstones to soak them in mineral spirits.



Bill Baker suggests you check that whetstone for flatness before using, they are not manufactured flat anymore--you must take the time to flatten them yourself.

Bill also suggests that when mortising for hinges, do all the mortising (double depth) on the door frame and none on the door.

Bud Froelich needed suggestions on using a green rubber wheel on a grinder. It was suggested that you slow down that grinder to 1/2 speed.

#### **JANUARY'S FEATURE PROJECT-- WALL HANGINGS**

Zatis Murphy showed us a sample of Barbara Cearly of New Ulm intarsia wall hanging made from Native Cedar with Walnut.

Chuck Maxwell showed us a Butterfly that that he made 11 years ago. Plans were in Popular Mechanic, Chuck had to make a jig for all the angles.

Dan Shaklovitz made a Victorian oak wall shelf, finished in Watco Oil. Plans were in the May/June 1990 Woodworkers Journal.

Lewis Vallette showed us a ship's wheel, using mortise and tenon joinery.

Don Sloan made a frame to house his collection of Arrow heads. The double frame has a slot for the glass and a slot for the plywood back.

Dennis Smith made a buck saw and on the buck saw blade he painted a scene, finished in Tung oil.

#### **FEBRUARY'S FEATURE PROJECT**

Valentine projects--Hearts, cupids, etc. anything associated with Valentine Day.

#### **SHOW AND TELL**

Bob Gallant made a truck that he deemed the Truck from Hell. What can go wrong can and did go wrong. He said that he built two of every thing just to get one truck. The truck was made out of Cherry and Padouk finished in three coats of Bartleys Gel Finish.

Scott Woods made a stake bed wagon for his grandson from Norm Abram plans.

Bud Froelich made a Shaker style table out of Poplar with a Pine top. The table has tapered painted legs, a drawer and a slant top writing desk on top. He also showed a matching two drawer file cabinet.

#### **JANUARY PROGRAM**

The program was presented by Kurt Papp of

PAPCO DISTRIBUTING--Weather shield windows and doors. Kurt's company makes custom windows and doors and also represents window manufacturers Anderson, Pella, Marvin and Weathershield.

They found that they could make round and arched windows cheaper than the manufactures. He uses furniture grade construction on all his custom windows.

Kurt explained some of the differences in the different types of glass, which is an education in itself.

Kurt has also become a member of our club, so if you have any questions about this subject, I'm sure he'll be glad to help you out.

Thank you Kurt for an interesting program.

#### **GROUP PURCHASE OF ALUMINUM CLAMPS**

The clamps have been ordered and should arrive in time to be delivered at the February Meeting. We ask that all of the members that purchased clamps please arrive early as Don and Sharon will be at Bayland Community Center by 8:30 A. M. with your purchase.

#### **BULK PURCHASES OF PENS AND PENCILS**

At the last meeting there was some interest in bulk purchasing of Pen and Pencil works to make the wooden pens and pencils. Don said that he would coordinate just as soon as we finished with the clamps. There is a big savings when you buy at least 200 pens or pencils, this way everyone can benefit from the price break without buying 200 individually.

#### **NEW TV WOODWORKING SHOW**

We received a press release from The Woodworkers' Store. They are sponsoring a new TV show called "Woodworking for Everyone" The program, based on projects from the book "Woodworking with Your Kids" by Richard Starr. The program is now airing on PBS stations across the nation. I have not seen it listed on KUHT Channel 8 but we might look for in the future. Remember The Woodworkers Store is also one of our advertisers.

#### **FEBRUARY MEETING**

**WHEN:** FEBRUARY 13, 1993 9:00 A. M.

**WHERE:** BAYLAND COMMUNITY CENTER  
ON BISSONNET AT HILLCROFT

**PROGRAM:** This month's program will be on How to Make Raised Panel Doors presented by Chuck Maxwell. You can make book that Chuck has made some jigs for those techniques that he uses. Chuck started making them on a shaper, then he went to one of those high raised panel bits you use on table mounted router and now he makes raised panels using one of the vertical safety panel bits. Chuck will describe them all. See you there.



TO JOIN W.W.C. OF HOUSTON FOR 1993, BRING TO THE REGULAR MEETINGS OR SEND YOUR DUES TO WOODWORKERS CLUB OF HOUSTON P.O. BOX 34481, HOUSTON, TEXAS 77234. MAKE CHECKS PAYABLE TO WOODWORKERS CLUB OF HOUSTON. SEE FORM BELOW FOR DUES INFORMATION.

Cut off and complete

LAST NAME \_\_\_\_\_ FIRST NAME \_\_\_\_\_

HOME PHONE \_\_\_\_\_ WORK PHONE \_\_\_\_\_

ADDRESS \_\_\_\_\_ CITY \_\_\_\_\_

STATE \_\_\_\_\_ ZIP \_\_\_\_\_ SPOUSE'S NAME \_\_\_\_\_

OCCUPATION/CRAFT:\*\* \_\_\_\_\_

RENEWAL MEMBERSHIP \_\_\_\_\_ \$18.00 NEW MEMBERSHIP \_\_\_\_\_ DUES ARE

PRORATED BY THE MONTH IN WHICH YOU JOIN.

\*\*\*\*\* PLEASE CIRCLE THE MONTH IN WHICH YOU JOIN.\*\*\*\*\*

JAN: \$18.00	APRIL: \$13.50	JULY: \$9.00	OCT: \$4.50
FEB: \$16.50	MAY: \$12.00	AUG: \$7.50	NOV: \$3.00
MAR: \$15.00	JUNE: \$10.50	SEPT: \$6.00	DEC: \$18.00

-----  
ANNUAL DINNER AND SHOW AND TELL

REGISTRATION

WOODWORKERS CLUB OF HOUSTON

FEBRUARY 27TH SATURDAY

RAMADA INN (HWY 290)

6:30 P.M.--FELLOWSHIP

7:30 P.M.--DINNER

COST: \$20.00 PER PERSON MEMBERS, MEMBERS SPOUSE AND NON-MEMBERS

MEMBER NAME \_\_\_\_\_

SPOUSE NAME \_\_\_\_\_

NON-MEMBER GUEST \_\_\_\_\_

Please enclose a check with your reservations. Make check payable to WOODWORKERS CLUB OF HOUSTON. Send check to JOE WAINRIGHT 5151 BRAESVALLEY Houston, Tex. 77096 666-8475

DEADLINE--DEADLINE--DEADLINE--DEADLINE--DEADLINE--DEADLINE

FEBRUARY 20TH, 1993-----FEBRUARY 20TH, 1993



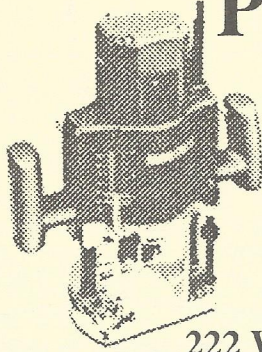

# Pasadena Industrial Supply

## BOSCH

# \$185

*Closeout Special!  
Quantities Limited!*

3 hp Variable Speed plunge router gives a "soft start" & delivers constant speed even under load. Provides speed range of 12000-18000 rpm. Plunge base has 3" stroke & can be set at 8 different plunge depths.

*We also have single speed & 220 volt versions available at similar savings*

222 West Pasadena Freeway, Pasadena Texas 77506 472-5588



5117 April Lane, Houston, Texas 77092

Hours: M-F 7:30-5:00 SAT 8:30-12:30

(713) 686-6176 Phone

(713) 686-3217 Fax

## DOMESTIC & IMPORTED HARDWOODS

Ash, Basswood, Birch, Cedar, Cherry, Cypress, Mahogany, Maple, Red Oak, White Oak, Padouk, Poplar, Purpleheart, Redwood, Sycamore, Teak, Virola, White Pine, Walnut, and More.

High Quality Domestic & Imported Plywoods, Softwoods, Hardwood Veneer Edgebanding & Hardwood Veneers

*Excellent Service & Competitive Prices!*

ON SITE CUSTOM MILLING TO YOUR SPECIFICATIONS, S2S, S2S1E, S4S

(No order too large or too small) 10/93

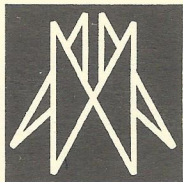
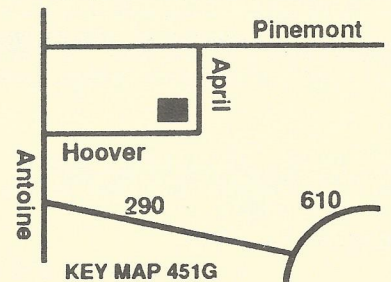

# AUSTIN HARDWOODS

13001 VETERANS MEMORIAL DR.

HOUSTON, TEXAS 77014

# 440-0764

We stock over 80 species of lumber including rare exotics and turning stock. Plywood, Veneer, Moulding, Flooring, Tools, Millwork, Paneling Etc. also available

Exp. 2/93

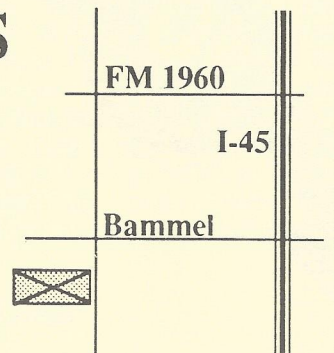



# HARDWOOD LUMBER CO.

700 E. 51/2 St. (In The Heights)  
Houston, Texas 77007  
(713) 862-6628  
Hours: M-F 7:30-5:00, Sat. 8:30-1:30

We stock over 65 species of lumber including  
hard to find exotics!

**Also:** Plywood, Veneer, Moulding, Formica,  
Custom Milling, Woodworking Tools, Books, etc.

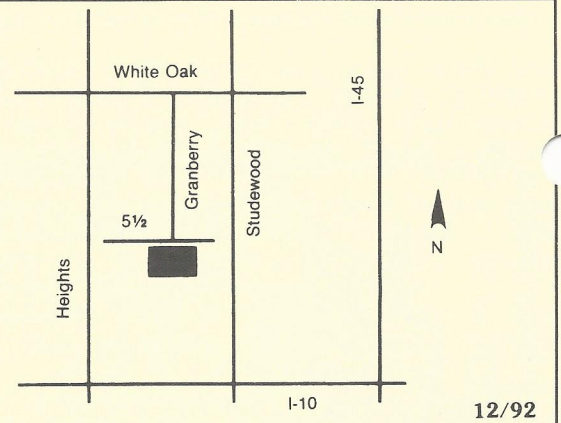

## Send Today for the Most Complete Catalog Selection of Woodworking Supplies

Please Enclose \$1.00 (3rd class) or \$2.00 (1st class)

Name \_\_\_\_\_

Address \_\_\_\_\_

City \_\_\_\_\_ State \_\_\_\_\_ Zip \_\_\_\_\_

**Orders Shipped Within 48 Hours**

7/93

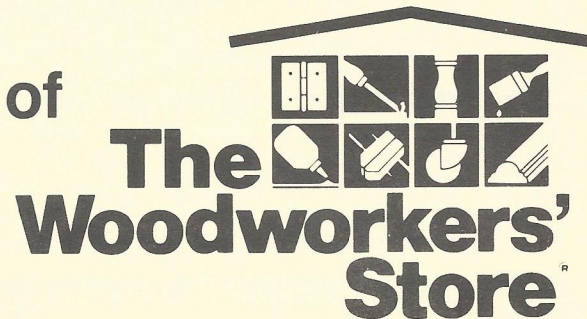

21801 Industrial Blvd., Rogers, MN 55374

PRINTED BY SPEEDY PRINTING SERVICE OF TEXAS 3727 W. ALABAMA, HOUSTON, TX. 77027 (713) 877-8466

Woodworkers Club of Houston  
P.O. Box 34481  
Houston, Tx 77234

