

April Meeting

New Safety 'Officer' Needed

Zatis announced at the end of last year that he was burning out after 2 years. For a while we have not had a Safety segment in our meetings. Some of the membership have asked about reconstituting it.

If you would rather not do a presentation each month at least we could have a safety column in the newsletter.

Problems and Solutions

David Cobb is looking for a good high gloss finish. Most of the suggestions were for Deft with multiple coats using light buffing with 0000 steel wool to create a bond. Another suggestion was to find the supplier of basketball floor finish or bowling alley finish.

Sharon Buckley is looking for plans to build replicas of antique 'ratchet' lamps. These are ones that have a post with notches and a lamp arm with matching notches to allow for variable height positioning.

Other members are looking for reviews on the Woodtek drill press and fine grandfather clock movements.

For those needing logs sawn contact Dennis Cox at 451-2926. He has a bandsaw mill, the price is dependent upon the size logs and thickness of the planks.

The Woodworking Show May 19, 20, and 21

WwCH has a booth to promote our club. Sharon Buckley is organizing our participation. We need members to setup the booth on Friday morning and then cleanup on Sunday. Then members need to sign up to be in the booth Friday afternoon, Saturday, and Sunday afternoon.

Besides the manning of the booth, this is an opportunity to show many of the fine work you have done. If you cannot work at least bring a piece or two to the May meeting for placing at the show. They will be cared for and returned at the June meeting.

Charity Gifts

Let us start working on items for the charity gifts and raffle. Art Chester is coordinating the work. (I have finished 2 cube puzzles in red oak.-ed.)

Show and Tell

Brian Honey- At the request of his wife Brian built a Magazine Rack on plans from Woodsmith. The end pieces are frame and raised panels requiring angled mortise and tenons with curved upper stiles and panels. The finish is Bartleys. Fine work, Brian.

Bill Hochmuth- As always, Bill created a fine music box using a metal disk movement. The disk movement was the early predecessor to the phonograph. Some disks were made as large as 30 inches. Bill's box is made of Red Cedar and Mesquite ('platinum' wood in Bill's terms). The finish is 2 coats of Watco then one coat used as to wet sand and a final coat of wax. You give us inspiration, Bill.

Bill Baker- Bill's wife needed clamps to hold her quilts and other wall hangings. The clamp is a nicely curved upper piece that with a brass screw and thumb nut.

Jimmie Harp- Showed a slatted headboard he made following an idea from Woodsmith. Using long leaf pine, instead of mortise tenons for the slats the curved top and straight bottom stiles were slotted and the slats spaced with filler pieces. A good solution to a difficult mortising situation. Good work, Jimmie.

Raffle Results

The rosewood Marking Gauge was won by Bob Pfiffner (a good going home gift) and the Try Square was won by Art Chester. Thanks to Brian and Woodcraft Supply.

New Members

Michael J. Drez
1931 Creekshire Dr.
Sugar Land, TX 77478

Geoffery Pass
3219 Leafy Pine Ct.
Kingwood, TX 77345
(713) 360-4063

William Wilkins
1217 Prairie
Houston, TX 77002

Membership Renewals

Tom Altman
12131 Meadowdale
Stafford, TX 77477
(713) 498-3097

Hubert Miller
P.O. Box 879
League City, TX 77574
(713) 332-5484

Telephone Number Changes

Bob Pfiffner (713) 376-9319
(going back to St. Louis area until December)

Jerry Dahlgard (713) 578-2051,
Office (713) 963-2090

Some Curve Mathematics by Walt Turpening

For many projects we need curves. We may laminate a shape, cut it with a bandsaw or bayonet saw or want a template for turning a shape. We want a curve to fit a particular space we can go to a math function to plot or draw the shape. Different functions can fit the bill. Each has subtle differences that may or may not make a difference. I have found that the subtle shapes come into play when the curve is large (on the order of feet).

The convenience of using the equations is to use a spreadsheet program to calculate variations of an equation, compare different curves and plot them. If you have access to a large plotter you can make full scale drawings for direct layout. However, I prefer to generate tables of points then use the tables to draw the curve on the wood or template material.

Here I show three curves and the functions that generate them: the parabola, cantenary and the Witch of Agnesi. My uses for these vary from ink blotters to rocking chair rockers. Sam Maloof uses a form of the Witch of Agnesi for the rockers on his signature rocker, the flattening of the tails prevents over tilting. Other rockers use the cantenary and the parabola.

The plots below were generated with Excel (on my Macintosh) using the following equations:

$$y = (6a^3/(x^2 + 4a^2)) \quad \text{Witch of Agnesi}$$

$$y = a(e^{x/a} + e^{-x/a})/4 \quad \text{Cantenary}$$

$$y = ax^2 \quad \text{Parabola}$$

The "a's" in the equations are constants for any particular curve but can be changed to alter the curvature. The value of "a" is the same for all other curves plotted below. The "e" in the Cantenary equation is the base for the natural logarithms and is a constant 2.71828183... (as far as my calculator will give it to me and close enough for most woodworking).

How I work is to have the spreadsheet calculate different curves using a range of "x's" and "a's" in the same equation. I plot them, like below, and then decide what proportions are pleasing for the intended piece. To help decide I may make a template in hardboard or even build a prototype in scrap plywood and "white wood" to test proportions.

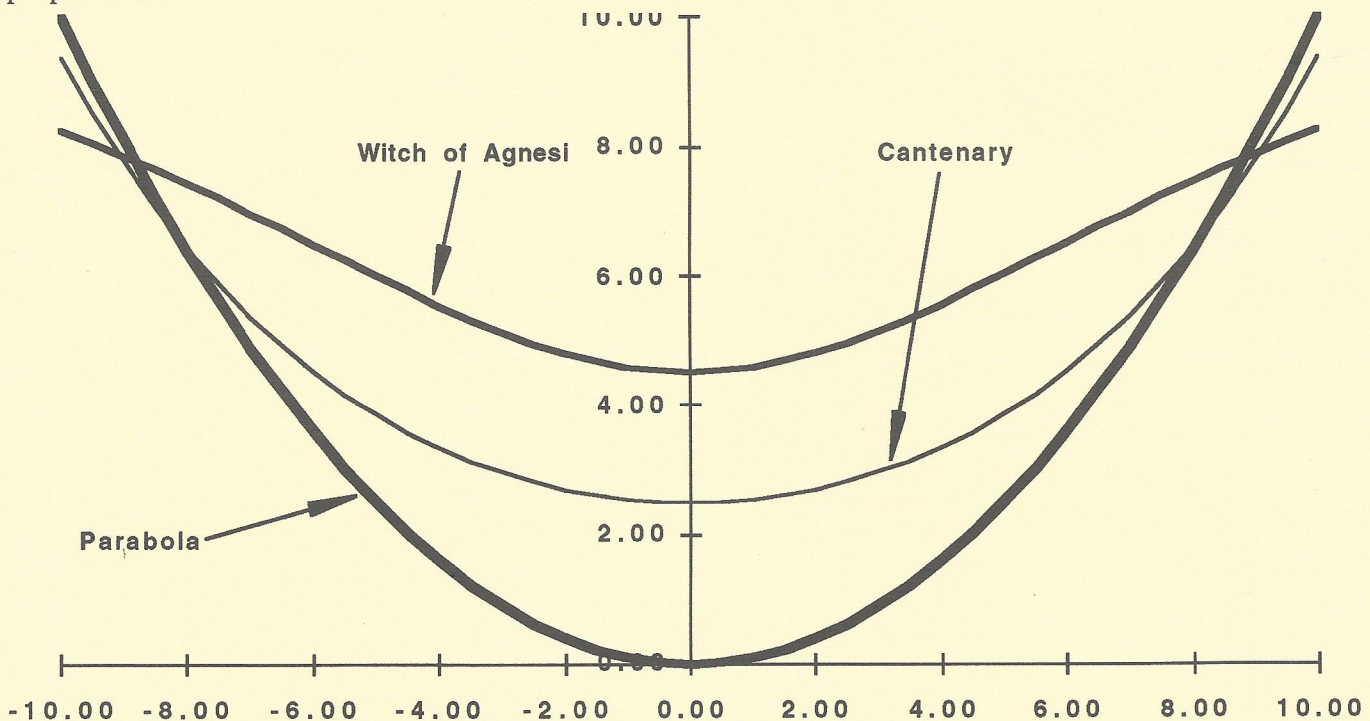

The units on the plot are the same horizontally and vertically but unspecified otherwise.

April Meeting

When: May 13, 1995 9:00 AM
Where: Bayland Community Center
on Bissonnet at Hillcroft
Program: Bruce Chance from Porter Cable.
(This is a rescheduling of an earlier
program.)

My Symphony

by
William Henry Channing

To live content with small means;
To seek elegance rather than luxury; and
refinement rather than fashion;
To be worthy, not respectable; and
wealthy, not rich;
To study hard, think quietly, talk
gently, act frankly;
To listen to the stars and birds,
to babes and sages, with open heart;
To bear on cheerfully, do all bravely,
awaiting occasion, worry never;
In a word to, like the spiritual,
unbidden and unconscious,
grow up through the common.

For Sale

18" Delta Scroll Saw with Stand, round table, almost
new (not used in last year). \$460
Contact: Art Chester 469-1990

1 hp Sears Craftsman Router with case and a few bits.
Rarely used and not at all in the last year. \$100.
Contact: Walt Turpening 879-5640

Shavings from the Editor's Bench

This month we have a rather thin issue. The April meeting was cut short due to the cancelation of the presentation from Freud at the last minute. I will take this opportunity to ask the membership to help in writing short articles for the newsletter. The pieces we present at the meetings all have unique techniques and methods of work that we should share with others that may not have been at the meeting. Also those who were there may have missed a particular point that they would like to try.

A big topic in bicycling magazines is finding time to ride. This extends from the riders wanting to maintain fitness to riders at the higher levels of regional and national competition.

For me the big concern is not so much about riding (I am not doing enough) but finding the time to do more woodworking. That is not to say that I lack projects I want to make. There are always my nut-crackers and small boxes, but I have a desire to build rocking chairs, foot stools, and other bigger pieces. The designs have been worked out on paper during business trips but getting to the lumber yards to select the materials is a pain since I have to work for money to spend on the lumber. Oh well, I will still make things.

For inspiration, I am really excited about **home furniture**, the new magazine from Taunton Press. The pieces they are showing are superb. I may not always like the designs of the more 'avant garde' work being shown but I admire the craftsmanship. Art furniture is always being done (not my style) and I admire the craftsman that uses an understanding of wood and traditional joinery to execute the piece. Have a look, there are a wide range of pieces shown from entertainment centers to beds to small chairs.

Officers

President	Jimmie Harp	664-4906
Vice President	Saul Harris	341-5373
Sec'y/Treas.	Lee Palfreyman	497-7085

Services

Book Library	Martin Imber	292-1606
Video Library	Denis Muras	943-7745
Literature Search	Don Richardson	661-1365
	Zatis Murphy	469-3563
Name Tags	Zatis Murphy	469-3563

Directors

Andy Anderson	723-1030
Art Chester	469-1990
Steve Procter	728-1459
Don Richardson	661-1365

Newsletter Editor - Walt Turpening, 879-5640

HARDWOOD LUMBER CO.

700 E. 51/2 St. (In The Heights)
 Houston, Texas 77007
 (713) 862-6628
 Hours: M-F 7:30-5:00, Sat. 8:30-1:30

We stock over 65 species of lumber including hard to find exotics!

Also: Plywood, Veneer, Moulding, Formica, Custom Milling, Woodworking Tools, Books, etc.

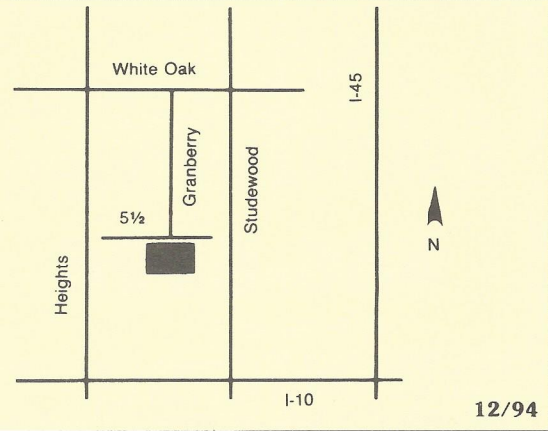

Send Today for the Most Complete Catalog Selection of Woodworking Supplies

Please Enclose \$1.00 (3rd class) or \$2.00 (1st class)

Name _____
 Address _____
 City _____ State _____ Zip _____

Orders Shipped Within 48 Hours

7/95

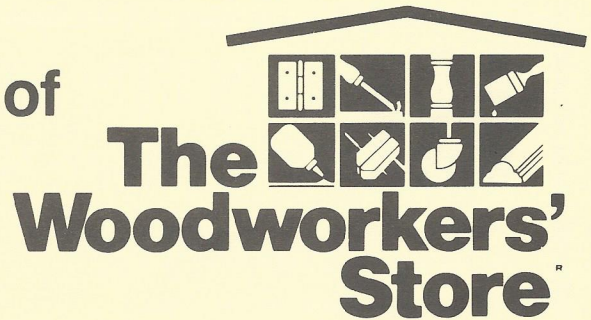

21801 Industrial Blvd., Rogers, MN 55374

See You At ☆ The Woodworking Show ☆

May 19, 20, and 21 at the Astro Arena Hall B

Don't shop for your tools in a tent! Dozens of distributors and thousands of other woodworkers will be at the Astro Arena for the first **National** woodworker's tool show in Houston for the past three years! Join us for a look at the newest in tools. See you at **Booths 225-227!**

Special for HAWC, WwCH & GCWA Members on Show Weekend:
 10% off on all Henry Taylor & Marples tools at the Astro Arena or in our store!
 7123 SouthWest Fwy, Just North of Bellaire Blvd. (713) 981-9228

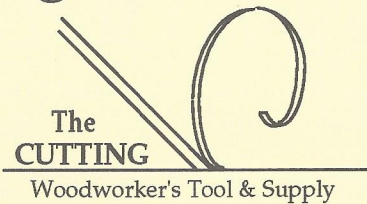

Mon. - Fri. 9 am to 6 pm
 Sat. 10 am to 5 pm
 Sun. Noon to 4 pm

WwCH Membership

To Join the Woodworkers Club of Houston for 1995, bring this form to a regular meeting or send your dues to:
 WOODWORKERS CLUB OF HOUSTON, P.O. BOX 34481, HOUSTON, TEXAS 77234
 Make checks payable to Woodworkers Club of Houston.

Renewal Membership \$24.00

New Membership is prorated if 1st year is less than 1 year.

WwCH Membership Form

Last Name _____ First Name _____
 Address _____ Spouse's Name _____
 City _____ Home Telephone _____
 State _____ Zip _____ Work Telephone _____
 Renewal Membership \$ _____ New Membership \$ _____

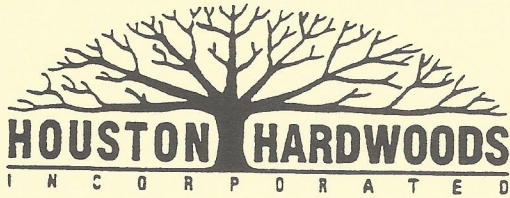

686-6176

FAX: 686-3217

4910 West 34th St, Houston, Texas 77092
Hours: M-F 7:30-5:00 SAT 8:30-12:30

DOMESTIC & IMPORTED HARDWOODS

Ash, Aspen, Basswood, Birch, Aromatic Cedar, Cherry, Cypress, Lacewood, Mahogany, Maple, Oak, Padouk, Pecan, Poplar, Purpleheart, Redwood, Sycamore, Teak, Walnut and more.

- *Quality Domestic & Imported Plywood (Interior & Marine)
- *Edgebanding & Veneer
- *Butcher Block Tops
- *MDF & Melamine
- *Moulding
- *PERSONAL SERVICE
- *PROMPT DELIVERY
- *ON-SITE CUSTOM MILLING

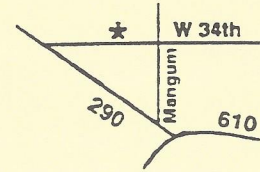

AUSTIN HARDWOODS

13001 Veterans Memorial Dr #408

- Rare Exotics - over 80 species in stock
- Turning Stock / Veneers / Dowels
- Flooring / Moldings / Plywoods
- Finishing Supplies
- Millwork & Woodwork available including Custom Profiles
- Custom Knife Grinding Services
- Project Hardware

2/95

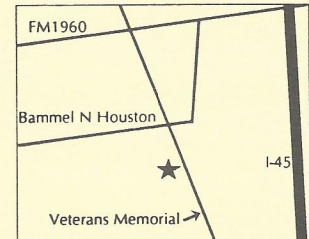

440-0764



WOODCRAFT®

Woodworking Tools • Books • Supplies
Since 1928

Woodcraft offers over 4,500 of the finest woodworking tools, books, supplies, cabinetry hardware, and wood available in the world today! We are committed to woodworkers of every skill level, from beginners to professionals, and every discipline, from carving to woodturning and fine cabinetry! Ask about our classes and demos next time you're in our neighborhood! We are an authorized dealer for Shopsmith, Delta, Porter Cable, Bosch, Record Marples and many more favorite, top quality brands!

Northbrook Shopping Center • 5360 West 34th Street • Houston, TX 77092 • 713-681-5200

4/95

EXCLUSIVE U.S.A. DISTRIBUTOR SWISS MADE CARVING TOOLS

Pasadena Industrial Presents *Our Spring '95*

Power & Hand Tool Show

May 19, 20 & 21

Fri 12 - 5:30 Sat 8:30 - 5:30 Sun 12 - 5:30

Free Hot Dogs
Drinks
Lots of Door Prizes!

Just Tell em "Johnny Sent Me!"
222 West Pasadena Freeway, Pasadena Texas 77536 472-5588



Woodworkers Club of Houston
P. O. Box 34481
Houston, TX 77234

Printed by: **Speedy Printing Service of Texas** 3433 West Alabama, Suite C • Houston, Texas • (713) 877-8466

Fine Handcraft Calendar of Events

Happenings in and around Houston

Woodworkers Club of Houston

Meeting: May 13, 1995 9:00 AM
at Bayland Community Center

Houston Area Woodcarvers Club

Meeting: May 20, 1995 9:00 AM
at Bayland Community Center

Gulf Coast Woodturners

Meeting: May 20, 1995 9:00 AM

Contemporary Handweavers of Houston

Meeting: May 18, 1995 7:00 PM
at First Presbyterian Church of Houston, 5300 Main near Fine Arts Museum.