

WOODWORKERS

CLUB OF HOUSTON

VOL. 4, NO. 11

NOVEMBER, 1988

Officers

Sharon Buckley - President
Kent Moore - Vice President
Don Richardson - Sec./Treasurer
Steve Procter - Newsletter Editor

Andy Anderson - Board of Directors
Jimmie Harp - Board of Directors
Ron Kuenning - Board of Directors
Hebert Wilbourn - Board of Directors

OCTOBER MEETING

Southwest Panel Products hosted our meeting in Katy Texas. Fred Omistad, the President, described their operations and history. Our thanks to SPP for an excellent meeting.

Southwest applies veneers on substrates for cabinet makers, and architectural woodwork mills. No order is too small, and they will deal with individual club members. They can lay up special panels for boardroom tables or other unique applications.

The substrates are usually particle board or medium density fiberboard, or MDF. MDF was developed for the furniture industry. It is flatter, smoother than veneer plywood, with no crossband needed, no warpage, no telegraphing thru the veneer, and moisture resistant. The density is great enough that the edge can be routed and stained. It has good screw holding capacity. Special screws are recommended.

The MDF is usually sized at 11/16, so two 1/32 veneers will finish out exactly at 3/4". This is a relief from new metric sized plywoods that are not 3/4".

Each panel is pressed, trimmed, sanded, and if desired, edge banded and cut to size on expensive, sophisticated European equipment. They include a computerized saw that can saw 99 cuts 99 ways.

Southwest collects veneers from all over the world.

Bookmatching is an alternating pattern created by flipping every other veneer. Slip matching is veneering in order the veneer was sliced from the log. Rift and Quarter saw oak is also available.

Reconstituted veneer is made from an African wood. It is no more expensive than Oak, but comes stained with aniline dyes to look like rosewood, for example.

Southwest began in the cabinet business 17 years ago, and got into the panel manufacturing business 3 years ago—originally

for their own consumption. They still build some computer furniture and custom furniture, but their main product is panels. They can usually fill an order in 3 days.

Again, thanks to Fred Omistad and Southwest Panel Products for graciously hosting our meeting.

Zatis Murphy talk was on eye safety. If a particle lodges in your eye, flush it out or get medical attention. Do not attempt to pull particles from the eyeball, get medical help! They may be able to save your sight if properly handled.

Chemicals can burn your eyes—either from direct contact (splashes, rubbing your eyes with your hands) or from fumes. Flush immediately—get medical attention. If possible, have someone help you flush your eyes—they can position your head under the faucet easier.

Eyeglasses alone are not sufficient protection. Use goggles or safety shield. Look for ANSI approved safety wear. Use these items when woodworking, and when working around your home. One of the most dangerous home tools is a weed-whipper—particularly when used as an edger. The line trimmer can fire objects into your face and eyes with as much force as your shop power tools.

PRESIDENT'S CORNER

By Sharon Buckley

The Charity Show has come and gone again. Our Total sales are still being tallied-up— if you have any money from outside sales Please see that Don Richardson gets it as soon as possible. From what we have already totaled we sold a little less than we did the previous year. But not from a lack of merchandise—Even though only 59 members contributed to the show we had close to \$8,000.00 dollars worth of merchandise.

I Thank Sam Zeisman for his hard work in finding us a location. You have no idea how

hard it is to get space in a Mall in Houston. Especially after N. W. Mall pulled the rug out from us at the last moment.

Don Sloan and Jimmy Harp for hauling all the items to and picking up the remaining merchandise from the mall.

The set-up crew- Bill Hochmuth, Claude Emory, Robert Sandlin, Ted King, Fred Olsen, Dan Shaklovitz, Lewis Valtette and Hebert Wilbourn.

Bill Boggs and Chuck Maxwell for hauling their own Shopsmith and Delta Scroll Saw to the Mall and for all their time they spent on demonstrations. Ed Caesar and Robert Sandlin who also helped with the demonstrations.

Last but not least the Sales Force which did a great job, Andy Anderson, Jack Armstrong, Bill Baker, Thad Brown, Ed Caesar, James Cooksey, Don Espey, Doc. Forkner, Tom Irvan, Jack Irvan, Ervie Jenkins, R.O. Johnson, Clarence King, Wayne Kennedy, Joe Marshall, Kent Moore, Perry Moreau, Zatis Murphy, Henry Reed, Don Richardson, Bill Sailans, Bob Soderblom, Earl Spradlin, Ken Wallis.

Thanks to everyone who helped--if I've forgotten anyone--Just chuck it up to my brain is beginning to turn to mush!

As Steve has noted the November Meeting will be Elections of Officers for 1989.

The Deadline for the Dinner Meeting was October 31, 1988. So if you want to attend--we can still get you in but you must sign up no later than the Nov. Meeting and sooner would be better.

Thanks again to everyone who helped make the 1988 Charity Show a Success! A big thanks to all of the members wives who not only helped our sales force but made all those purchases.

PROBLEMS AND SOLUTIONS

Jimmy Harp seeks plans for a sleigh bed. (sounds kinky, doesn't it?)

Chuck Maxwell illustrated how to sharpen a forstner bit. There are six (6) edges to sharpen. Do not sharpen the outside perimeter or the bit will bind (and change size). Use small, odd shaped stones to reach the edges.

BUY AND SELL

There were numerous persons with items to sell in their vehicles. Just like a swap meet!

Leonard Ekholm--10" Montgomery Ward Radial Saw--\$100.00.

Murray Gordon--Shopsmith equipment, including jointer, jigsaw and bandsaw. See him for details.

R.H. Bomar--485-3378--Antique Early Maple Work Bench 6' long with 2 vises.

SHOW AND TELL

Don Richardson--Salad Servers from exotic woods.

Jimmy Harp--Copy of an antique rocker cradle, Oak with dovetails, finished in watco.

Ken Wallis--Safe stepstool in maple. Copy of stool used in SW Bell switch rooms. Maple with Bartley's. Stool and bench for charity show.

Gayle Robinson--Puzzie and a wild screw?

SAFETY

The Following is from an anonymous author.

A LESSON IN SAFETY PLANNING

"I am a bricklayer by trade. On the day of the accident, I was working alone on the roof of a new six story building. When I completed my work, I discovered that I had about 500 pounds of brick left over. Rather than carry the bricks down by hand, I decided to lower them in a barrel by using a pulley which fortunately was attached to the side of the building at the sixth floor. Securing the rope at ground level, I went to the roof, swung the barrel out and loaded the bricks into it. Then I went back to the ground and untied the rope, holding it tightly to insure a slow rate of descent. Note that I weigh 135 pounds. Due to my surprise at being jerked off the ground so suddenly, I lost my presence of mind and forgot to let go of the rope. Needless to say, I proceeded at a rapid rate up the side of the building. At about the third floor, I met the barrel coming down. This explains my fractured skull and broken collarbone. Slowed only slightly, I continued my ascent, not stopping until the fingers of my right hand were two knuckles deep into the pulley. Fortunately, by this time I had regained my presence of mind and was able to hold tightly to the rope in spite of the pain. At about the same time, however, the barrel of bricks hit the ground--and the bottom fell out of the barrel. Devoid of bricks, the barrel now weighed about 50 pounds. As you might imagine, I began a rapid descent. At about the third floor, I met the barrel coming up. This accounts for the two fractured ankles and lacerations of my legs and lower body. The encounter with the barrel slowed me enough to lessen my injuries when I fell onto the pile of bricks, and fortunately, only three vertebrae were cracked. I am sorry to say, however, that as I lay there on the bricks, in pain, unable to move, and watching the empty barrel six stories above--I again lost my presence of mind. I let go of the rope!

I hope you members plan your woodworking better than he planned his bricklaying.

SHOP TALK

By Don Sloan

Don't be backward. I have been doing quite a lot of bandsawing. How many hours you should get out of a 1/8" blade is hard to say. Sometimes I can cut for days and no problems. One thing for sure--if you saw for three hours, shut it down for an hour and then saw again, I noticed I got longer blade life. Then I saw an ad in Garrett-Wade for Cool Blocks--What the

heck why not try them out. They work great- don't heat up-less friction and so far, longer blade life. Will let you know later how the 1/16" blade works.

CLUB NEWS

The December meeting is scheduled for Thursday December 1, at the Rice Faculty Club. The cost is \$12.50 per person, \$25.00 per couple. This is our annual dinner meeting, with a grand show and tea and induction of officers. The food is excellent--so get your reservation in now!

NOMINATION FOR OFFICERS

President Bill Hochmuth
Vice-President Bill Sallans
Secretary/Treasurer Bill Baker
Board of Director Claude Denson
Board of Director Gary Wallace

Sharon Buckley and Don Richardson will serve on the Board as outgoing officers. Steve Procter has agreed to edit the Newsletter another year.

CLINICS AND WORKSHOPS

October-Don Richardson-Computer Aided Design
November-Ken Wallis-Stave Bowl Construction

The November Clinic will be held following the regular Business Meeting--Starting at 1:00P.M. at Chuck Maxwell's Shop-10614 Winfern. This is a demonstration not a hands on--Chuck said he can handle many more people than cars--He can easily park 12 cars, if you want to attend you might want to check with another member and car pool.

Ken Wallis has spent a lot of time setting this one up and should be very informative. Remember to bring a chair if you want to sit !

ANNOUNCEMENTS

We want to Welcome a New Advertiser to our Newsletter--Pasadena Industrial Supply, 222 West 225 Freeway, Pasadena, Texas.

All the members keep asking about a Woodworkers Tool Show--Pasadena Industrial is having their Fall show this November. They set up a big tent with over 25 manufacturers displaying their best Hand and Power Tools, most at a discount price for the show.

All of the members and their guests of the Woodworkers Club of Houston are invited. Be sure to tell them you are a member and you and your guest get in free.

PASADENA SHOW DATES

Friday-----November 11th-----12:00-5:30
Saturday----November 12th----- 8:00-5:30
Sunday-----November 13th-----12:00-5:30

ANNUAL DUES

DEADLINE JANUARY 31, 1989

TO JOIN W.W.C. OF HOUSTON FOR 1989, BRING TO THE REGULAR MEETINGS OR SEND YOUR \$18.00 ANNUAL DUES TO WOODWORKERS CLUB OF HOUSTON P.O. BOX 34481, HOUSTON, TEXAS 77234. MAKE CHECKS PAYABLE TO WOODWORKERS CLUB OF HOUSTON.

Cut off and complete

LAST NAME _____ FIRST NAME _____

HOME PHONE _____ WORK PHONE _____

ADDRESS _____ CITY _____

STATE _____ ZIP _____ SPOUSE'S NAME _____

OCCUPATION/CRAFT:** _____

NAME OF EMPLOYER _____

*OPTIONAL FOR USE IN CLUB "ROSTER BOOK"(TO BE PUBLISHED IN 1989) FOR SURE THIS YEAR!!!!!!!!!!!!!!

NOVEMBER MEETING

WHEN: NOVEMBER 12, 1988 9:00 A.M.

**WHERE: ELKS LODGE #151
5230 SOUTH WILLOW DR.
HOUSTON, TEXAS**

PROGRAM: FINISHING

There has been such interest in Bartley's Paste Stains and Varnish. John Hall from A-1 in Nacogdoches is the distributor for Bartley's and Van Williams of MVP Sharpeners the local retailer will do a program on finishing with Bartley's Paste Products.

DIRECTIONS: Take South Loop 610 and exit on South Post Oak--Go past Willowbend to the next intersection with a Traffic Light, this is Willow turn right. Approximately 6 blocks and your there!

SEE YOU THERE !!!!!!!!!!!!!

NEWSLETTER INFO

THE DECEMBER NEWSLETTER

PLEASE NOTE: BECAUSE OF THE THANKSGIVING HOLIDAYS AND THE DECEMBER 1 MEETING--THE LAST DAY FOR PUBLISHING IS NOVEMBER 17. THE NEWSLETTER WILL BE MAILED THE WEEK OF NOVEMBER 21.

Would you like to advertise in the **WOODWORKERS CLUB OF HOUSTON NEWSLETTER** ? For a flat fee of \$100.00 you will have your business listed in 12 issues of this newsletter and receive a **Membership Roster**, updated periodically, with the names and addresses of all members.

Pasadena Industrial Supply Power & Hand

Nov. 11, 12 & 13

Fri. Sat. Sun.

12-5:30 8-5:30 12-5:30

Tool Show

Free admission to all members of the
Woodworkers Club of Houston and their guests!

Over 25 manufacturers
will be displaying their
best hand & power tools
for your enjoyment!

222 West 225 Freeway, Pasadena Texas 77536 472-5588

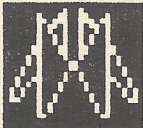

AUSTIN HARDWOODS

13001 VETERANS MEMORIAL DR.
HOUSTON, TEXAS 77014

440-0764

WE STOCK OVER 80 SPECIES OF LUMBER INCLUDING
RARE EXOTICS AND TURNING STOCK

PLYWOOD, VENEER, MOULDING, FLOORING, TOOLS,
MILLWORK, PANELING, ETC. ALSO AVAILABLE

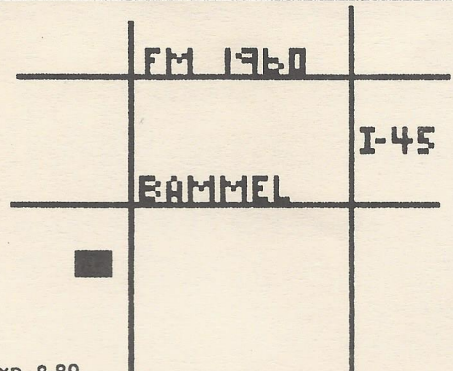

Exp. 8-89



Woodworkers Club of Houston
P.O. Box 34481
Houston, TX 77234

ALLWOOD/SCHROEDER INC

Imported & Domestic

Marine Plywood
Parana Pine
Mahogany

Teak
Exotic Hardwood
Domestic Hardwood

Quality

Hardwood - Softwoods - Plywood

Mouldings & Squares

Self-service

A complete selection of finishing supplies

WALNUT - BIRCH - ASH - CHERRY

CYPRESS - RED AND WHITE OAK

SUGAR PINE AND OTHERS

MON. - FRI. 8:00 TO 5:00

SAT - 8:00 TO 1:00

5401 Lawndale

(713- 921-6131)

Exp. 5/89

HARDWOOD LUMBER CO.

700 E. 51/2 St. (In The Heights)
Houston, Texas 77007
(713) 862-6628
Hours: M-F 7:30-5:00, Sat. 8:30-1:30

We stock over 65 species of lumber including
hard to find exotics!

Also: Plywood, Veneer, Moulding, Formica,
Custom Milling, Woodworking Tools, Books, etc.

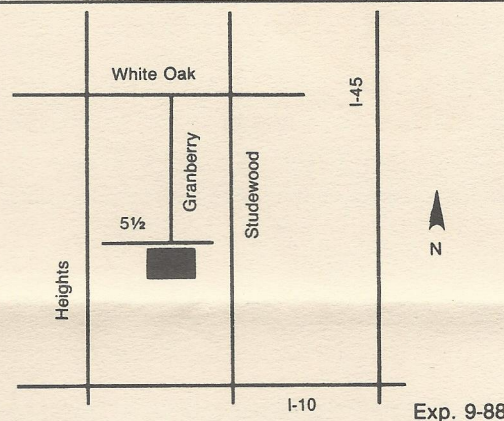

Send Today for the Most Complete Catalog Selection of Woodworking Supplies

Please Enclose \$1.00 (3rd class) or \$2.00 (1st class)

Name _____

Address _____

City _____ State _____ Zip _____

Orders Shipped Within 48 Hours

Exp. 5/89

21801 Industrial Blvd., Rogers, MN 55374

