

Woodworkers Club

OF HOUSTON

VOL. 7, NO. 7

JULY, 1991

Officers

Zatis Murphy - President 469-3563
Denis Muras - Vice President 943-7745
Leo Orinderff - Sec./Treasurer 445-5460
Sharon Buckley - Newsletter Editor 944-6739

Board of Directors

Claude Emory - 861-3495
Ted King - 351-6808
Don Richardson - 661-1365
Lewis Vallette - 643-2014

JUNE MEETING SPECIAL PRESENTATION

The Club presented Dr. Bill Forkner with a special plaque of appreciation for his continuing support of the Woodworkers Club of Houston. Throughout the years he has allowed us to hold our meetings at the University of Houston Industrial Arts Wood shop, he has presented a variety of programs at our meetings and shared with us his vast array of expertise.

Of course the plaque was made out of Maple, because we all know that Doc believes there are two types of wood-- Maple and firewood.

Thank you Doc for your good humor and willingness to share and promote woodworking with all the members.

JUNE PROGRAM

The June program was presented by Gerald Polmateer of Hardwood Lumber Co. at the Heights location.

Gerald took us through the process of how lumber goes from the log, through the kiln, the grading process, to wood identification and ideas on how to make a better and more stable finished product.

First the best lumber is cut in the winter because when it is cut in the summer it has more defects. It is then graded and talled green. The lumber is stickered and allowed to air dry before entering the kiln. They place the stickered pieces right at the end of the boards as the lumber will split right up to the stick because of air circulation. Most defects occur in the first stages in the air drying yard.

When the lumber is first placed in the kiln, the kilns temperature is between 105 to 120 degrees with a humidity level of 95%. The target moisture is 6 to 8 percent.

Hardwoods are dried by moisture content not by time, but softwoods are dried by time not moisture content.

They try to dry the wood as fast as they can because it will yield less defects.

When Gerald chooses lumber for a project he prefers rough lumber as he can see what the wood will do when cut.

STICKER STAIN--- Poplar and basswood stains bad--check every two feet for these stains because if it has sticker stain the stain will go through the entire thickness of the board

WOOD IDENTIFICATION-- Soft Maple looks like a chicken walked all over--little tracks--if olive green its Hard Maple.

The difference between White Birch and Maple is some time hard to detect but look on the board edge--Hard Maple have rays that gleamer.

Red and White Oak--Red Oaks grain pattern is like Ash, it has little marks not over 1" while White Oak has very long marks.

Ash is yellowish white--there is Southern Ash and Northern Ash. The Northern Ash grows slower which results in tighter rings. Bugs get into the sapwood in the log stage turning heartwood brownish.

All the best lumber comes off the outside of the tree as the limbs break off the new wood covers up the knots so all the defects are in the center of the tree.

One advantage of working with low moisture content wood is that if you have made sloppy joints when the wood swells you get tighter joints.

The best way to achieve a very stable piece is to place veneer on both sides of a plywood core.

RAISED PANEL DOORS-- Before you start cutting that expensive hardwood, first make a mock up out of cheap lumber if you don't like it now, you won't like it out of good wood. Also light and dark woods can change the looks of a piece--so if your finished piece is to be out of dark wood paint your mock up piece a dark color and see how it looks.

Gerald prefers his projects to be symmetrical and have an upward lift. He prefers his pieces to speak softly instead of loudly.

Gerald recommends the books by James Krenov, The Fine Art of Cabinetmaking and The Impractical Cabinetmaker.

SAFETY

With no formal discussion planned on safety Zatis asked for an open discussion on safety from the membership.

Don Sloan wanted to know if there was any device that would help him hear the phone while wearing hearing protectors in the shop. Radio Shack sells a couple of devices--one unit will turn on a lamp in your shop when the phone rings, another device uses a loud buzzer and strobe light that flashes when the phone rings, you can use just the buzzer or just the strobe or in combination.

Chuck Maxwell demonstrated a electrical tester to test the plugs in your shop or home, it has three lights that will tell you if you have wired correctly and sells at Home Depot for about \$4.00.

PROBLEMS AND SOLUTIONS

A member wanted to know if a conical sander could or could not be used on the quill feed on a Shopsmith, the instructions said you could and you couldn't--anybody know?

Guy Meaders wanted suggestions on how to eliminate glue from sticking to his wooden hold downs. One suggestion was to wax the clamps with paraffin or bees wax.

SHOW AND TELL

Art Chester made a school desk for his grandchildren from the prototype that Chuck Maxwell had the previous month. Art added additional support under the desk top.

One of our members is a High School Industrial Arts Teacher, he demonstrated some of the items that his students make in class. One was a Walnut Bow saw, they made their own hardware and purchased the blades from the Frog Tool Co. He also had a foot stool covered in Formica and an electrical quad outlet with cord holder.

Tom Gathright showed a very severe piece of twisted Holly.

Zatis Murphy explained that after receiving a lathe as a gift from his wife, he enrolled in the 3 day lathe class that shopsmith offers. He showed us some of the projects that he made in the class: A simple bowl with a Walnut strip in the middle, a bud vase with a lathe duplicator, a bowl made with a ring master and a rolling pin. The course cost \$150.00 which includes all equipment and wood. They suggest that you bring your own lathe tools as they also cover sharpening.

Stuart Murphy demonstrated how he turned a damaged trombone into a renaissance instrument.

FOR SALE AND WANT TO BUY

For Sale: Craftsman 6" Jointer on casters, includes a sharpended set of blades, very good condition. \$150.00 contact Harry Jacobsen 465-4153.

JULY MEETING

WHEN: JULY 13, 1991 9:00 A. M.

**WHERE: BAYLAND COMMUNITY CENTER
ON BISSONNET AT HILLCROFT**

PROGRAM: The program will be presented by Perry Henderson on detailed Models In wood. The program will include the design process and techniques for building highly detailed models.

WOOD CHUCKLES By Gayle Robinson

Last week, there were two workers finishing up a house project. One was sawing off some rafter ends over-head when he accidentally dropped his saw! The falling saw struck his partner and cleanly lopped off his ear.

They quickly gathered up the ear, packed it in some ice and rushed to the hospital.

The team of doctors did a very quick and careful job of re-attaching the ear and before completely bandaging the man's head got a mirror and asked him to inspect their handiwork.

When he saw what they had done, he screamed that it was not his ear that was now in place!

The doctors were quite perturbed about this, and questioned him about how he knew that this was not his ear!!!!

His reply----My ear had a pencil behind it !!!!!!!

CHARITY SHOW

Don't forget we need lots of merchandise for the charity show and sale.....It seems like a long way off but its just around the corner-- lets all get going now.

SEE YOU ALL AT THE MEETING!!!!!!!!!!!!!!!!!!!!!!



Pasadena Industrial Supply



Power Tool & Accessory
Headquarters for;
Delta Machinery, Porter-Cable
Milwaukee, Hitachi, Bosch,
Makita, Skil, Saftey-Speedcut
& More!

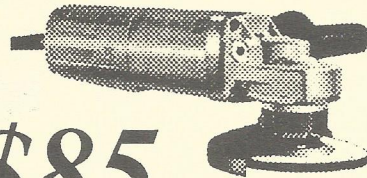

\$85

4 -1/2" RA Grinder
Powerful 5.5 amp motor runs at 10,000 rpm.
Includes guard & grinding wheel. Standard
5/8" NC arbour for wide accessory availabil-
ity. Lightweight at 4 1/2 lbs.

Milwaukee #6140 4 1/2" RA Grinder

222 West Pasadena Freeway, Pasadena Texas 77506 472-5588

Hardwood Lumber Co. Lawndale Division Imported and Domestic

Quality
Hardwoods - Softwoods - Plywoods
Mouldings & Squares

A COMPLETE SELECTION OF FINISHING SUPPLIES.

Marine Plywood
Parana Pine
Teak

Honduran Mahogany
Exotic Hardwoods
Domestic Hardwoods
WALNUT - BIRCH - ASH - CHERRY
CYPRESS - RED AND WHITE OAK
AND OTHERS

MON. - FRI. 7:30 TO 4:30
SAT. 8:00 TO 1:00

5401 Lawndale
(713) 921-6131

Exp. 12/90

Your Complete Woodworking Center Check Out Our Hardwoods, Our Prices Are Low

Hours:
Monday to Friday:
10:00 a.m. to 8:00 p.m.
Saturday
9:00 a.m. to 5:00 p.m.

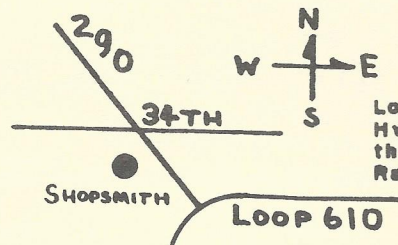

Shopsmith Inc.

Located at 34th St. &
Hwy. 290 to Austin on
the West side in the
Randalls Strip Center.

Northway Shopping Center
10965A Northwest Frwy.
Houston, TX 77092
Phone: (713) 681-5200

Exp. 1/91

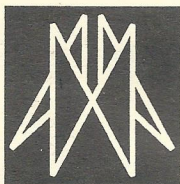

AUSTIN HARDWOODS

13001 VETERANS MEMORIAL DR.
HOUSTON, TEXAS 77014

440-0764

We stock over 80 species of lumber including rare exotics and turning stock. Plywood, Veneer, Moulding, Flooring, Tools, Millwork, Paneling Etc. also available

Exp. 8/89

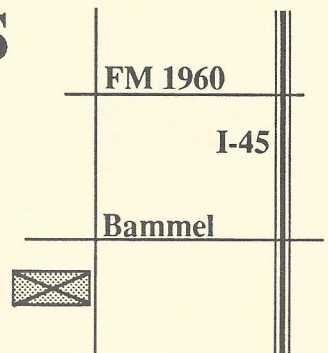

HARDWOOD LUMBER CO.

700 E. 51/2 St. (In The Heights)
Houston, Texas 77007
(713) 862-6628
Hours: M-F 7:30-5:00, Sat. 8:30-1:30

We stock over 65 species of lumber including hard to find exotics!

Also: Plywood, Veneer, Moulding, Formica, Custom Milling, Woodworking Tools, Books, etc.

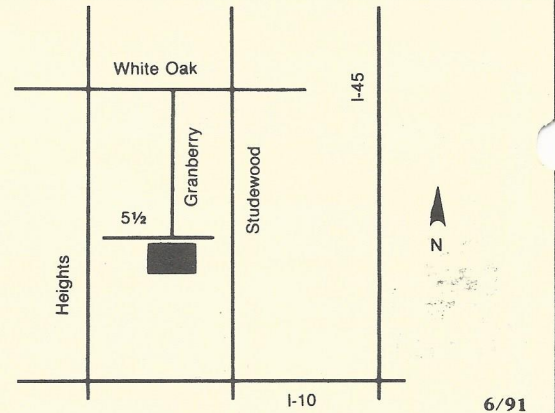

Send Today for the Most Complete Catalog Selection of Woodworking Supplies

Please Enclose \$1.00 (3rd class) or \$2.00 (1st class)

Name _____
Address _____
City _____ State _____ Zip _____

Orders Shipped Within 48 Hours

1/92

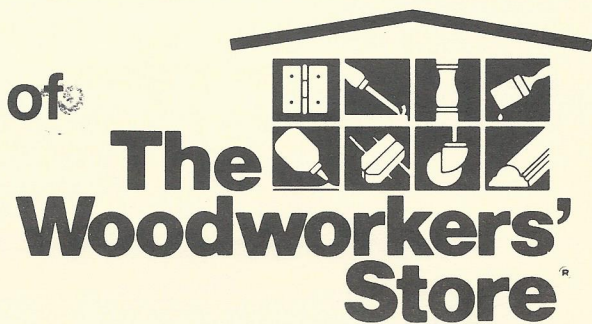

21801 Industrial Blvd., Rogers, MN 55374

PRINTED BY SPEEDY PRINTING SERVICE OF TEXAS 3727 W. ALABAMA, HOUSTON, TX. 77027 (713) 877-8466



5117 April Lane, Houston, Texas 77092
Hours: M-F 7:30-5:00 SAT 8:30-12:30
(713) 686-6176 Phone
(713) 686-3217 Fax

DOMESTIC & IMPORTED HARDWOODS

Ash, Basswood, Birch, Cherry, Mahogany, Maple, Red Oak, White Oak, Poplar, Walnut Etc.

High Quality Domestic & Imported
Plywoods, Softwoods, Hardwood Veneer
Edgebanding & Hardwood Pliable Veneers
Excellent Service & Competitive Prices!

ON SITE CUSTOM MILLING
TO YOUR SPECIFICATIONS,
S2S, S2SIE, S4S
(No order too large or small)

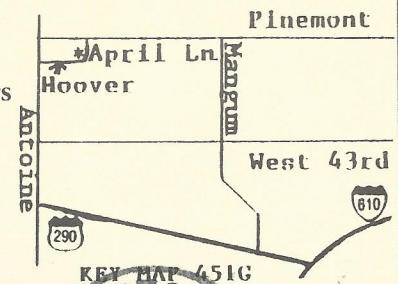

Expires 8/91

Woodworkers Club of Houston
P.O. Box 34481
Houston, Tx 77234

