

# Woodworkers Club

## OF HOUSTON

VOL. 7, NO. 3

MARCH, 1991

### Officers

Zatis Murphy - President 469-3563  
Denis Muras - Vice President 943-7745  
Leo Orinderff - Sec./Treasurer 445-5460  
Sharon Buckley - Newsletter Editor 944-6739

### Board of Directors

Claude Emory - 861-3495  
Ted King - 351-6808  
Don Richardson - 661-1365  
Lewis Vallette - 643-2014

### FEBRUARY MEETING

The February program on Design was presented by Dr. Bill Forkner.

Design must incorporate function--does it do the job it was designed to do. Analyze your design--does it offer function, styling, physical character, value/cost and human factors.

One of the biggest problems are curves--curves progress from a single element, repeat curve or change direction for a more pleasing shape also you should have a right angle break between curves.

Misuse of curves can ruin a project, always remember the curve of force must be drawn free hand. Guidelines for a curve--use of more than one French Curve and move them around.

Doc suggests that we look at commercial furniture makers for ideas.

The following are design variations:  
1). Element and Variation--beads, shoulders and breaks.

2). Element and Repeat

3). Repeat in reduced size.

4). Repeat in Reverse

For good design limit your turning to 3 different diameters: outside, breaks and inside curve.

The force and weight of a piece is transferred to the legs. Make sure that the minimum diameter of a turning is sufficient to support the weight.

Craftsmanship is no good if design is no good. In museums you can find ugly and uncomfortable pieces of furniture because they were not used. Good design furniture is used and used up.

There is much more to design than can be covered in a half hour program, Dr. Forkner gave us the high lights, he also has a design book that he has written for his classes and offered it for sale to the membership for \$10.00.

We would like to thank Dr. Forkner for this program and his continuing support and participation in the club.

### PRESIDENT'S CORNER

By Zatis Murphy

I find woodworking a very enjoyable hobby. Indeed, I look forward to my retirement in four years when I can spend more time making sawdust, more than just an occasional weekend. I've also found that this hobby can be expensive. Thus, I look for ways to save money.....although I may be "penny wise and pound foolish."

Have you ever looked around the house, kitchen, bathroom or garage to see what everyday items you might have to assist you in your woodworking projects? Here are a few things I've found helpful.....and the best part is they are virtually free!

I use little paper drinking cups (not the wax coated kind) for mixing small amounts of putty, glue, paint and such. When I'm through, I throw them away; no cleanup, and no mess. Small, disposable aluminum baking pans make good containers for cleaning paint brushes. Plastic containers from grocery store, the kind that cottage cheese or sour cream come in, are handy as paint containers; the plastic lid on these allows one to seal the container for use later. Plastic picnic knives are good for applying glue to small projects; the serrated blade helps distribute the glue evenly. Plastic spoons are great for measuring dry ingredients. Plastic measuring cups are great for dipping out liquids. Old-fashioned, spring clothes pins and rubber bands make good clamps for small items. And don't forget the aluminum foil, plastic wrap, wax paper and paper towels. (OK. So these aren't free.) You'll find a myriad of uses for them.

What have you found around the house that's helpful! Why not tell us about it in the newsletter or at our next meeting. You'd be surprised at how many of us might have overlooked it!

## ANNOUNCEMENTS

### MESQUITE FOR SALE.....

Algaroba of Texas, Inc. P.O. Box 203  
Brady, Texas 76825 (915) 597-2681  
There regular price is \$5.80 per bd. ft. , now reduced to \$3.90 per bd. ft. for rough sawn, random width and length, bundled in approximately 10 bd. ft. bundles. Average length will be 24", good one side with small defects on opposite sides. Thickness is 3/4, 4/4, and some 5/4 boards. Minimum shipment is 20 bd. ft., sent UPS, lumber and freight collect. They also have a good selection of 1 1/4" x 1 1/4" up to 2" x 2" turning blocks, at the same price. Sale ends March 31, 1991.

### CRAFTERS VILLAGE

This is an Artists and Crafters Mall where you can display your crafts. You rent the space per month, the mall is open daily. Spaces vary in price starting at \$48.00. The main information center is just off Beltway 8 at 10321 Club Creek Dr. at Beechnut---telephone No. 880-5406.

### CAM CLAMP

Zatis had some cam clamps from England selling for \$12.95 each or 4 for \$45.00. We are trying to find out if we can get a better price if we buy as a group.

### WORKSHOPS AND CLINICS

April 20 Murray Gordan will hold a workshop on Wooden Screw clamps. Murray can only accomodate a maximum of 6 members if you are interested contact Stuart Murphy or Murray.

Stuart is in the process of setting a date for bandsaw boxes by Bill Beggs.

Stuart needs more members to help in hosting these clinics and workshops.

### PROBLEMS AND SOLUTIONS

Ed Caesar needed a way to remove a water stain from wood. Place mayonaise on the spot for a couple of days and then rub down all of the wood and your stain is gone.

### BUY AND SELL

Items that are mentioned for sale at the meeting are not listed in the next month's newsletter because by the time we go to press the item has been sold.

If you would like to list an item call or drop Sharon a note at least 2 1/2 weeks before the next meeting because the newsletter goes to the printer 2 weeks before the meeting.

### WANTS TO BUY

Al Ferdinando wants to buy a Sander 6" belt with a 9" disk and a 12" Planer contact him at 447-4259.

## SHOW AND TELL

L. D. Greenwood showed us a chair and chest that he copied from the Bartley's Kit Collection. He used the chair pattern from a friend and made 10 chairs from scratch. He also made a dining room table which seats 14 people made from Honduras Mahogany.

Chuck Maxwell showed how he made his own knobs for a sliding cut-off table, plans are in the February Woodsmith.

Ken Wallis had a request for a kitchen table small enough for a mobile home but could expand for a bigger home. Ken of course made it from bowling alley maple with 3 extension 10" wide (the width determined by the width of his planer). Ken finished the top with 3M Scotch Guard and the legs with Bartley's Finish.

Jud Sevy made a book stand that would fit next to a bed like a hospital table tray. He used brass screws from a toilet tank with t-nut. To hold the book open he uses bicycle clamps.

Bill Hochmuth made some music boxes. One with a 36 note movement in a Walnut box. the movement plays two tunes within a 360 degree of rotation. Bill also made a music box out of zebra wood and walnut with a 72 note 3 tunes, each tune in 360 degree rotation, the keys are no more than 1/64 long. Drum shifts in axial position for the 3 tunes to play.

Bill says he is not computer literate--but determined the size of the box to be the same size as a Dutch Master cigar box (blunt style cigar size).

Joan Brueggeman said that she and her husband do a lot of traveling and got tired of carrying a couple of boxes for their coffee. So she made a case to carry all the items.

### MARCH MEETING

WHEN : MARCH 9TH, 1991 9:00 A. M.

WHERE: BAYLAND COMMUNITY CENTER  
ON BISSONNET AT HILLCROFT

PROGRAM: USE OF MEASUREMENTS  
Gayle Robinson will present a program on the use of measurements.

DIRECTIONS: The Bayland Community center is just west of Hillcroft on Bissonnet.

To get there you can go out the Southwest Freeway (Highway 59 South) take the Hillcroft exit. Go south on Hillcroft, turn right on Bissonnet and the Bayland Community Center is on the right. Follow the signs in the park to the community center.

Another way to get there and avoid the Southwest Freeway is to take the Braeswood exit off the South 610 Loop--go west Hillcroft turn North to Hillcroft till you get to Bissonnet--turn left (west) and the Bayland Park is just to the right.

# Pasadena Industrial Supply

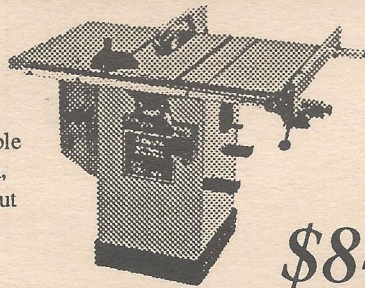

## 10" Tilting Arbour Saw From

**DELTA**

- 0 & 45 adjustable from table top • 2 hp 230 volt TEFC motor
- Miter gauge & rip fence storage • Motor cover included
- Auto overload protection with push button switch
- T slotted table provides support for miter gauge beyond table edge

Power Tool & Accessory

Headquarters for;

Delta Machinery, Porter-Cable  
Milwaukee, Hitachi, Bosch,  
Makita, Skil, Saftey-Speedcut  
& More!

**\$849** Delta# 36-755

222 West Pasadena Freeway, Pasadena Texas 77536 472-5588

## Hardwood Lumber Co. Lawndale Division Imported and Domestic

Marine Plywood  
Parana Pine  
Teak

Honduran Mahogany  
Exotic Hardwoods  
Domestic Hardwoods  
WALNUT - BIRCH - ASH - CHERRY  
CYPRESS - RED AND WHITE OAK  
AND OTHERS

MON. - FRI. 7:30 TO 4:30  
SAT. 8:00 TO 1:00

Quality  
Hardwoods - Softwoods - Plywoods  
Mouldings & Squares

5401 Lawndale  
(713) 921-6131

A COMPLETE SELECTION OF FINISHING SUPPLIES.

Exp. 12/90

## Your Complete Woodworking Center Check Out Our Hardwoods, Our Prices Are Low

Hours:  
Monday to Friday:  
10:00 a.m. to 8:00 p.m.  
Saturday  
9:00 a.m. to 5:00 p.m.

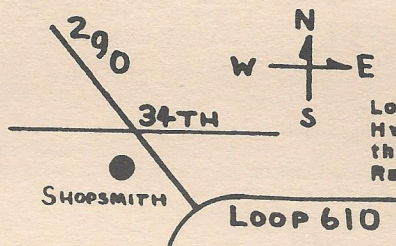

**Shopsmith Inc.**

Located at 34th St. &  
Hwy. 290 to Austin on  
the West side in the  
Randalls Strip Center.

Northway Shopping Center  
10965A Northwest Frwy.  
Houston, TX 77092  
Phone: (713) 681-5200

Exp. 1/91

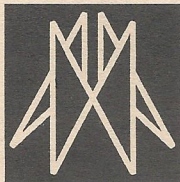

## AUSTIN HARDWOODS

13001 VETERANS MEMORIAL DR.  
HOUSTON, TEXAS 77014

**440-0764**

We stock over 80 species of lumber including rare exotics and turning stock. Plywood, Veneer, Moulding, Flooring, Tools, Millwork, Paneling Etc. also available

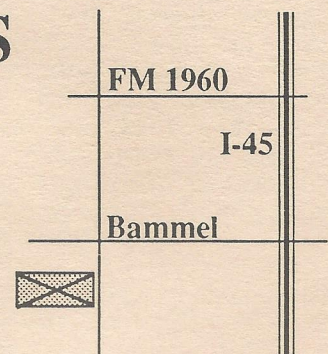

Exp. 8/89

## HARDWOOD LUMBER CO.

700 E. 51/2 St. (In The Heights)  
Houston, Texas 77007  
(713) 862-6628  
Hours: M-F 7:30-5:00, Sat. 8:30-1:30

We stock over 65 species of lumber including hard to find exotics!

**Also:** Plywood, Veneer, Moulding, Formica, Custom Milling, Woodworking Tools, Books, etc.

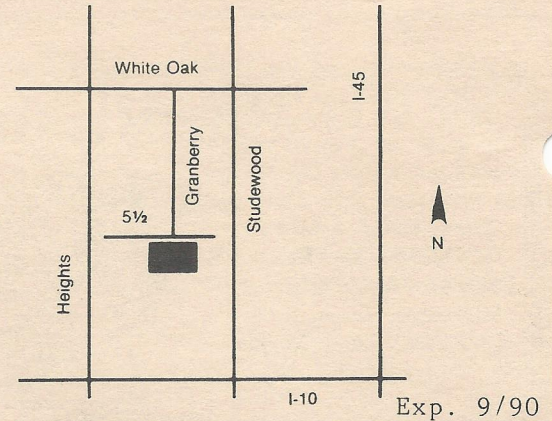

## Send Today for the Most Complete Catalog Selection of Woodworking Supplies

Please Enclose \$1.00 (3rd class) or \$2.00 (1st class)

Name \_\_\_\_\_  
Address \_\_\_\_\_  
City \_\_\_\_\_ State \_\_\_\_\_ Zip \_\_\_\_\_

Orders Shipped Within 48 Hours

Exp. 1/91

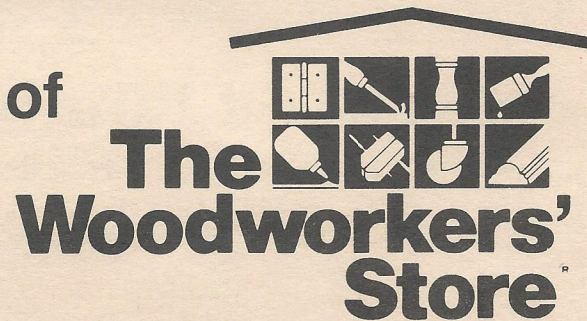

21801 Industrial Blvd., Rogers, MN 55374

PRINTED BY SPEEDY PRINTING SERVICE OF TEXAS 3727 W. ALABAMA, HOUSTON, TX. 77027 (713) 877-8466



5117 April Lane, Houston, Texas 77092  
Hours: M-F 7:30-5:00 SAT 8:30-12:30  
(713) 686-6176 Phone  
(713) 686-3217 Fax

### DOMESTIC & IMPORTED HARDWOODS

Ash, Basswood, Birch, Cherry, Mahogany, Maple, Red Oak, White Oak, Poplar, Walnut Etc.

High Quality Domestic & Imported Plywoods, Softwoods, Hardwood Veneer Edgebanding & Hardwood Pliable Veneers  
*Excellent Service & Competitive Prices!*

ON SITE CUSTOM MILLING TO YOUR SPECIFICATIONS, S2S, S2SIE, S4S  
(No order too large or small)

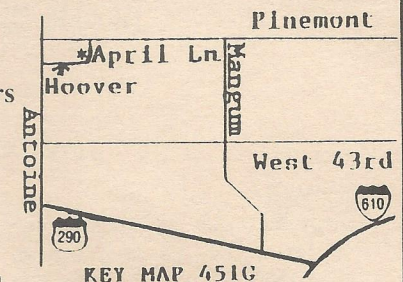

Expires 8/91

Woodworkers Club of Houston  
P.O. Box 34481  
Houston, Tx 77234