

Woodworkers Club

OF HOUSTON

VOL. 8, NO. 10

OCTOBER, 1992

Officers

Denis Muras - President 943-7745
Jack Conry - Vice President 463-7352
Bill Smith - Sec./Treasurer 695-3827
Sharon Buckley - Newsletter Editor 944-6739

Board of Directors

Ed Burger - 497-5718
Joe Cook - 862-5623
Zatis Murphy - 469-3563
Don Sloan - 688-8986

SEPTEMBER MEETING

David Marsh of Marsh furniture presented his very unusual concept of woodworking and his equally unusual business style.

While in college and lacking money for furniture he made a very primitive table that to his amazement everyone that visited his home wanted one. So while in college he started making simple primitive pine pieces.

By the time he finished college he was making money with his woodworking, so he decided to stay with it.

As his self taught woodworking skills progressed, his style of woodworking advanced into fine hardwoods and fancy joinery. He is always pushing his limits, accepting any commission no matter how difficult or demanding. If the commission was beyond his skills he would learn how to accomplish these woodworking skills.

But after four years and a three year waiting list of commissions this extremely stressful work load had affected his health and David said that the fun had gone out of woodworking.

Out of this dilemma he formed his present company, 13 years ago. He had always enjoyed the primitive furniture that he grew up with as a youth and the furniture that he made in college.

Primitive furniture or furniture made by our ancestors that just needed furniture and could not afford store bought. This furniture depicts a more casual life style, very liveable furniture.

Marsh Furniture makes limited production pieces, he does not offer a catalogue of his furniture and does not accept commissions.

He sells to 20 stores in 17 states, Marsh Furniture delivers a truck load of furniture in their own trucks. The merchant does not know what he is getting just a truck load of Marsh Furniture. Because he sells to only one merchant in each town they have an exclusive and because they may not make that same

piece for months, the customer will usually buy the piece not knowing when the merchant will ever get another one.

If the merchant has a piece that he cannot sell Marsh Furniture will take it back, this also gives them good checks and balances. Also they will repair or replace any piece that is damaged.

Marsh uses only wood from farmed forests and also salvaged wood. Since they use mainly #3 common shelving with all the warps, twists, and knots, you have to make the piece interesting: 1). FORM 2). TEXTURE--By using a hand plane, this gives texture and a different look. They also distress a piece by using a distressed stick with sheet rock screws and or a pipe with nuts and bolts welded on for texture or BEAUTY MARKS, and 3). PAINT.

Our ancestors were better finishers because their finishes were layered giving the finished piece depth.

The Painting steps begin with a latex wash (they salvage all the paint culls they can find) then the piece is sanded, the next coat is Minwax Early American thinned down 2 parts to 1, this wash gives tone, each time sanding through, then using sheet rock mud in slurry form they completely coat the piece, turning the piece white, again they sand the piece which also smooths the pine, they finish up with sanding sealer and a laquer finish.

Marsh Furniture uses historic precedence to made the furniture familiar but they are not copies. Today's furniture must be more functional to meet today's society--a pie safe today is not used for the same functions as our ancestors.

David prefers to work at his workbench than at a desk, with this in mind he does not limit his employees, each employee develops his own product line, no constrictions, the woodworker develops the products and improves them. From this philosophy MARSH FURNITURE did over 2 million in sales last year.

The company has grown to 45 employees,

ranging in age from 18 to 75 years. Starting with one workshop his business has grown to six shops, soon he will be building a seventh shop, yes they build their own 6,000 square foot workshops and each woodworker builds their own workbench.

Working in teams each shop makes its own wage and bonus by their productivity.

David believes that woodworking should be fun and that it should make the client happy. Nature's greatest design is a smile, so on the back of each piece of furniture you will find a HA or HA HA, plus scratched into the back are the names of the craftsman that worked on this piece of furniture.

Marsh Furniture has one shop in Houston and five shops in Hempstead. Hempstead offers a good stable work force and reasonable land prices.

Their furniture can be seen in Houston at 1710 Sunset.

We asked David if we could visit his shops and he said that right now they are extremely busy but would probably have time in the spring. In the Spring. He hopes to try out a new concept in allowing half of his employees to take off two months while the other half works and then reverse the whole process--to keep his employees from getting burned out.

Remember mistakes are your joys and flaws are part of the piece (Beauty Marks). Always have fun with your woodworking.

We would all like to thank David for sharing with us his business and woodworking skills, a very different and interesting program.

OFFICERS FOR 1993

At the October meeting we will be nominating officers for the 1993 year and we will be voting on them in November. When called upon to serve please say yes, it doesn't take that much time and you will enjoy being a part of the course of the club.

CHARITY SALE--OCTOBER 24 AND 25

ITS' HERE!!!!!!!!!!!!!!!!!!!!

This years sale will be at the same location in the Greenspoint Mall as last year's. We will be in the court intersection leading to Foley's and Montgomery Ward's. If you will be delivering merchandise enter at West end of the mall at gate 12.

Please tag your projects with your membership number and a price, if you want the price to be firm add an F after the price.

Bill Hochmuth needs a few more workers for the charity sale, also for set up on Friday morning and for take down on Saturday night.

SEPTEMBER PROJECT----Puzzles

Dennis Muras project was an elephant puzzle, plans are from the American Woodworker.

Joe King made a Walnut marble pump.

Ken Wallis puzzle was from Wood magazine, cut out on the bandsaw.

OCTOBER PROJECT

The project for October is outdoor projects.

SHOW AND TELL

Chuck Maxwell had a brand new cut off jig. Plans in Sept./Oct. Woodworkers Journal.

Bill Hochmuth made a mirror that he saw in an advertisement for Minwax.

Jimmie Harp made a doll bed complete with miniature quilt with dust ruffles, no he didn't make the quilt his wife did.

Robert Sandlin donated frog and cat clocks for the charity show.

Joe Cook made workbenches for a Day Care center with wheels on one end so that they could be moved easily for storage.

Tom Gathright made a clock from plans in Wood magazine and a birch hallway plant stand.

Joe Wainwright made a Kaleidoscope of maple and walnut.

Dan Shaklovitz donated a doll high chair from bowling alley maple and pirana pine. He also made a TV trays and stand from Ash finished in Bartley's.

Lewis Vallette showed us the first bowls that he turned on his new lathe, which he built himself.

Denis Muras made a hound dog, a hopping frog and a caterpillar.

John made a magazine rack out of cherry with birch dowels, finished in Minwax cherry stain.

Monte Laramore made a scooter, plans in Weekend woodworking magazine.

WOODWORKING SHOW

Pasadena Industrial will have its annual Fall tent show this month. Johnny will have demonstrations, good prices, and refreshments. The price is right, just tell them Johnny sent you and you get in for Free. The show will be Halloween weekend, that's October 30, 31 and November 1. See Pasadena's ad for further information and time of the show.

OCTOBER MEETING

WHEN: OCTOBER 10, 1992 9:00 A. M.

WHERE: BAYLAND COMMUNITY CENTER
ON BISSONNET AT HILLCROFT

PROGRAM: The program will be presented by Don Siegal of Nasa on woodworking.

Pasadena Industrial *Presents-* *Our Fall '92*

Power & Hand Tool Show

HALLOWEEN WEEKEND!!

Come See

What's

New!

Door Prizes!
Special Pricing!
Free Hot Dogs & Drinks!
Continuous Demonstrations!

OCT. 30 & 31
NOV. 1

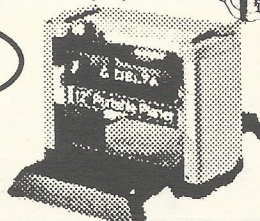

Fri 12 - 5:30 Sat 8 - 5:30 Sun 12 - 5:30

P.S. When our people ask for \$2 admission at the door, just tell them "Johnny sent me"

222 West Pasadena Fwy Pasadena, TX (713)472-5588 or 1(800)433-2875

Hardwood Lumber Co. Lawndale Division Imported and Domestic

Quality
Hardwoods - Softwoods - Plywoods
Mouldings & Squares

A COMPLETE SELECTION OF FINISHING SUPPLIES.

Marine Plywood
Parana Pine
Teak

Honduran Mahogany
Exotic Hardwoods
Domestic Hardwoods
WALNUT - BIRCH - ASH - CHERRY
CYPRESS - RED AND WHITE OAK
AND OTHERS

MON. - FRI. 7:30 TO 4:30
SAT. 8:00 TO 1:00

5401 Lawndale
(713) 921-6131

12/92



AUSTIN HARDWOODS

13001 VETERANS MEMORIAL DR.
HOUSTON, TEXAS 77014

440-0764

We stock over 80 species of lumber including rare exotics and turning stock. Plywood, Veneer, Moulding, Flooring, Tools, Millwork, Paneling Etc. also available

Exp. 2/93

FM 1960

I-45

Bammel



HARDWOOD LUMBER CO.

700 E. 51/2 St. (In The Heights)
Houston, Texas 77007
(713) 862-6628
Hours: M-F 7:30-5:00, Sat. 8:30-1:30

We stock over 65 species of lumber including
hard to find exotics!

Also: Plywood, Veneer, Moulding, Formica,
Custom Milling, Woodworking Tools, Books, etc.

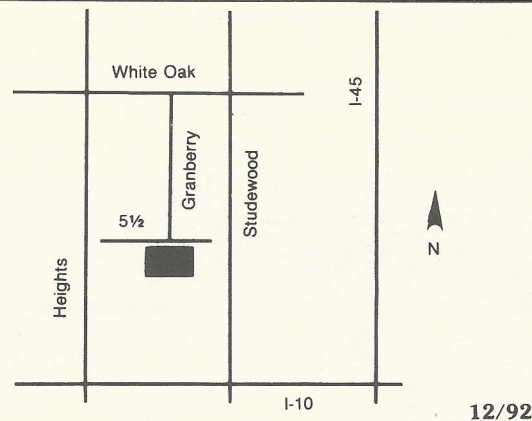

Send Today for the Most Complete Catalog Selection of Woodworking Supplies

Please Enclose \$1.00 (3rd class) or \$2.00 (1st class)

Name _____
Address _____
City _____ State _____ Zip _____

Orders Shipped Within 48 Hours

7/92

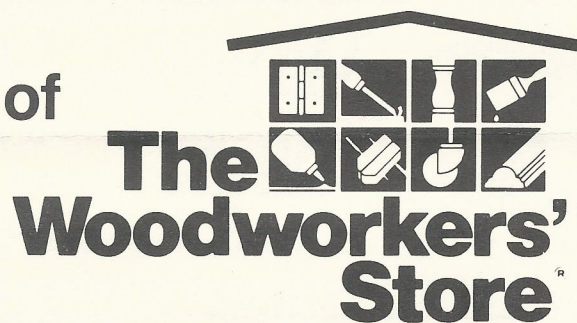

21801 Industrial Blvd., Rogers, MN 55374

PRINTED BY SPEEDY PRINTING SERVICE OF TEXAS 3727 W. ALABAMA, HOUSTON, TX. 77027 (713) 877-8466



5117 April Lane, Houston, Texas 77092
Hours: M-F 7:30-5:00 SAT 8:30-12:30
(713) 686-6176 Phone
(713) 686-3217 Fax

DOMESTIC & IMPORTED HARDWOODS

Ash, Basswood, Birch, Cedar, Cherry, Cypress, Mahogany, Maple, Red Oak, White Oak, Padouk, Poplar, Purpleheart, Redwood, Sycamore, Teak, Virola, White Pine, Walnut, and More.

High Quality Domestic & Imported
Plywoods, Softwoods, Hardwood Veneer
Edgebanding & Hardwood Veneers

Excellent Service & Competitive Prices!

ON SITE CUSTOM MILLING
TO YOUR SPECIFICATIONS,
S2S, S2S1E, S4S
(No order too large or too small)

10/92

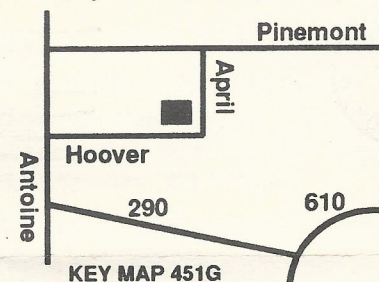

Woodworkers Club of Houston
P.O. Box 34481
Houston, Tx 77234

